



PROJECT PLANS FOR PILLAR POINT HARBOR RESTAURANT/STORE SIDEWALK EXPANSION PROJECT SAN MATEO COUNTY HARBOR DISTRICT, CALIFORNIA

ABBREVIATIONS

AB	AGGREGATE BASE
AC	ASPHALT CONCRETE
AVE	AVENUE
BM	BENCH MARK
BOC	BACK OF CURB
BOW	BACK OF WALK
BS_CHK	BACKSIGHT CHECK
C&G	CURB AND GUTTER
CATV	CABLE TELEVISION BOX
CB	CATCH BASIN
CC	CONCRETE
CCP	CONCRETE PAD
CCW	CONCRETE WALL
CDF	CONTROLLED DENSITY FILL
CIP	CAST IRON PIPE
CP	CONTROL POINT
CMP	CORRUGATED METAL PIPE
CRN	CROWN
DI	STORM DRAIN INLET
DIM	DIMENSIONS
DWY	DRIVEWAY
E	EAST
(E)	EXISTING
EB	ELECTRICAL BOX
EG	EXISTING GRADE
ELEC	ELECTROLIER
EP	EDGE OF PAVEMENT
ETW	EDGE OF TRAVELED WAY
FG	FINISHED GRADE
FH	FIRE HYDRANT
FL	FLOWLINE
FND	FOUND
FNL	FENCE LINE
FOC	FACE OF CURB
FT	FEET
GB	GRADE BREAK
GM	GAS METER
GRD	GROUND
GV	GAS VALVE
HCR	HANDICAP RAMP
INV	INVERT ELEVATION
LA	LATERAL
LF	LINEAR FEET
LG/LOG	LIP OF GUTTER
LT/L	LEFT
LS	LANDSCAPE
MON	MONUMENT
(N)	NEW
N	NORTH
NE	NORTHEAST
NTS	NOT TO SCALE
NW	NORTHWEST
OH	OVERHEAD
PB	PULL BOX
PCC	PORTLAND CEMENT CONCRETE
PGE	PACIFIC GAS & ELECTRIC
PST	POST
ROW	RIGHT OF WAY
RT/R	RIGHT
S	SOUTH
S	SLOPE
SB	SERVICE BOX
SD	STORM DRAIN
SDCB	STORM DRAIN CATCH BASIN
SDMH	STORM DRAIN MANHOLE
SE	SOUTHEAST
SF	SQUARE FEET
SSCO	SANITARY SEWER
SSMH	SANITARY SEWER CLEANOUT
STA	SANITARY SEWER MANHOLE
ST	STATION
ST	STREET
SW	SOUTHWEST
S/W	SIDEWALK
T	TELEPHONE/TREE
TC/TOC	TOP OF CURB
TYP	TYPICAL
UNK	UNKNOWN
U.O.N	UNLESS OTHERWISE NOTED
VG	VALLEY GUTTER
VLT	VAULT
W	WEST
W	WATER
W/	WITH
WM	WATER METER BOX
WV	WATER VALVE

GENERAL NOTES

- ALL WORK SHALL BE DONE IN ACCORDANCE WITH THE 2015 STANDARD SPECIFICATIONS FOR PUBLIC WORKS CONSTRUCTION, 2015 CALTRANS STANDARD PLANS, 2016 CALIFORNIA BUILDING STANDARDS CODE, AND AS SHOWN ON THE PROJECT PLANS AND SPECIAL PROVISIONS.
- THE LOCATION OF SURFACE UTILITIES SHOWN ON THESE PLANS IS APPROXIMATE ONLY. ATTENTION IS DIRECTED TO THE POSSIBLE EXISTENCE OF UNDERGROUND FACILITIES NOT KNOWN OR IN A LOCATION DIFFERENT FROM WHICH IS MARKED IN THE STREET, SHOWN ON THE PLANS, OR IN THE SPECIAL PROVISIONS. IT IS THE CONTRACTOR'S RESPONSIBILITY TO VERIFY THE LOCATION AND ELEVATION OF ALL EXISTING UTILITIES WITHIN THE WORK AREA PRIOR TO CONSTRUCTION. THIS VERIFICATION SHALL BE COORDINATED BY THE CONTRACTOR WITH THE APPROPRIATE UTILITY COMPANY AS REQUIRED. THE CONTRACTOR SHALL NOTIFY UNDERGROUND SERVICE ALERT U.S.A. 1-800-227-2600 (OR DIAL 811) 72 HOURS PRIOR TO COMMENCING DEMOLITION, EXCAVATION, OR UNDERGROUND WORK.
- THE CONTRACTOR SHALL COMPLY WITH ALL STATE, COUNTY, AND DISTRICT LAWS AND ORDINANCES, REGULATIONS OF THE DEPARTMENT OF INDUSTRIAL RELATIONS, O.S.H.A., AND COMMISSION ON HEALTH AND SAFETY AND WORKER'S COMPENSATION RELATING TO SAFETY AND CHARACTER OF WORK, EQUIPMENT AND LABOR PERSONNEL.
- THE ENGINEER ASSUMES NO RESPONSIBILITY BEYOND ADEQUACY OF THE DESIGN CONTAINED HEREIN. CONTRACTOR AGREES TO ASSUME SOLE AND COMPLETE RESPONSIBILITY FOR JOB SITE CONDITIONS DURING THE COURSE OF CONSTRUCTION OF THIS PROJECT, INCLUDING SAFETY OF ALL PERSONS AND PROPERTY, THAT THIS REQUIREMENT SHALL APPLY CONTINUOUSLY AND NOT BE LIMITED TO NORMAL WORKING HOURS, AND THAT THE CONTRACTOR SHALL DEFEND, INDEMNIFY AND HOLD THE OWNER AND ENGINEER HARMLESS FROM ANY AND ALL LIABILITY, REAL OR ALLEGED, IN CONNECTION WITH THE PERFORMANCE OF WORK ON THIS PROJECT, EXCEPT FOR LIABILITY ARISING FROM THE SOLE NEGLIGENCE OF THE OWNER OR ENGINEER.
- THE CONTRACTOR SHALL SUBMIT TRAFFIC CONTROL PLANS TO THE ENGINEER/INSPECTOR FOR APPROVAL PRIOR TO THE START OF ANY WORK. TRAFFIC CONTROL SHALL BE PERFORMED IN ACCORDANCE WITH THE REQUIREMENTS OF THE LATEST "CALIFORNIA MANUAL ON UNIFORM TRAFFIC CONTROL DEVICES" PUBLISHED BY CALTRANS, AND AS REQUIRED IN THE PROJECT SPECIFICATIONS. THE CONTRACTOR SHALL PROVIDE TEMPORARY PEDESTRIAN ACCESS TO PROPERTIES DURING ALL CONSTRUCTION PHASES. TRAFFIC CONTROL PLAN SHALL SHOW HOW ACCESS WILL BE PROVIDED AND ACCOMPLISHED FOR PEDESTRIANS. THE CONTRACTOR SHALL MAINTAIN VEHICULAR AND PEDESTRIAN ACCESS THROUGHOUT THE PROJECT AT ALL TIME UNLESS EXPRESSLY AUTHORIZED BY THE DISTRICT TO DO OTHERWISE.
- THE CONTRACTOR SHALL BE HELD RESPONSIBLE FOR ANY FIELD CHANGES MADE WITHOUT WRITTEN AUTHORIZATION FROM THE DISTRICT.
- THE CONTRACTOR SHALL PROVIDE ALL LIGHTS, SIGNS, BARRICADES, FLAG MEN, OR OTHER DEVICES NECESSARY TO PROVIDE PUBLIC SAFETY IN ACCORDANCE WITH THE CURRENT EDITION OF THE STATE OF CALIFORNIA DEPARTMENT OF TRANSPORTATION MANUAL ON UNIFORM TRAFFIC CONTROL DEVICES (MUTCD).
- THE CONTRACTOR IS RESPONSIBLE FOR MATCHING EXISTING STREETS, SURROUNDING LANDSCAPE, AND ALL OTHER EXISTING CONDITIONS WITH A SMOOTH TRANSITION IN PAVING, CURBS, GUTTERS, SIDEWALKS, GRADING, ETC., AND TO AVOID ANY ABRUPT OR APPARENT CHANGES IN GRADES OR CROSS SLOPES, LOW SPOTS, AND HAZARDOUS CONDITIONS.
- THE CONTRACTOR SHALL EXERCISE EXTREME CAUTION WHEN WORKING IN THE VICINITY OF HIGH VOLTAGE STREET LIGHT CIRCUIT AND OTHER POTENTIALLY HAZARDOUS UTILITY INSTALLATIONS. IF ANY STREET LIGHT CIRCUITS ARE DAMAGED OR INTERRUPTED, THE CONTRACTOR SHALL CONTACT THE DISTRICT STREET LIGHT CREW IMMEDIATELY FOR EMERGENCY REPAIR. THE CONTRACTOR SHALL COMPENSATE THE DISTRICT FOR ANY COST RELATED TO THE REPAIR OF THE STREET LIGHT CIRCUIT.
- ELEVATIONS INDICATED IN THE DRAWINGS ARE BASED ON AVAILABLE INFORMATION DURING PREPARATION OF THE DRAWINGS. ANY SIGNIFICANT DEVIATIONS FROM THE ACTUAL SITE CONDITIONS SHALL BE REPORTED TO THE DISTRICT.
- THE CONTRACTOR SHALL NOTIFY DISTRICT'S PUBLIC WORKS DEPARTMENT PRIOR TO CUTTING AND OR REMOVING ANY TREE ROOTS LARGER THAN 1 INCH IN DIAMETER TO ALLOW DISTRICT ARBORIST TO INSPECT AND MAKE RECOMMENDATIONS.
- HAUL ROUTES SHALL BE ONLY ON STREETS PRE-APPROVED BY THE DISTRICT.
- THE CONTRACTOR SHALL COMPLY WITH ALL APPLICABLE LOCAL, STATE, AND FEDERAL REQUIREMENTS REGARDING MATERIAL, METHODS OF WORK, AND DISPOSAL OF EXCESS AND WASTE MATERIALS.
- THE CONTRACTOR SHALL OBTAIN ALL REQUIRED INSPECTION AND PERMITS, AND PROVIDE NOTICES REQUIRED BY THE DISTRICT.
- THE CONTRACTOR SHALL CONTROL DUST CAUSED BY THE WORK. DAMPEN SURFACES AS REQUIRED WITH WATER. CONTRACTOR SHALL COMPLY WITH POLLUTION CONTROL REGULATIONS OF THE DISTRICT.
- ANY SURFACE UTILITIES, SUCH AS MANHOLES, VALVES, MONUMENTS, DRAIN INLETS, DETECTOR HANDHOLES AND UTILITY BOXES SHOWN TO BE WITHIN CONSTRUCTION LIMITS SHALL BE ADJUSTED IN ELEVATION TO MATCH THE FINISHED ROADWAY SURFACE. UTILITY COVERS SHALL NOT BE STRIPED OVER.
- THE CONTRACTOR SHALL NOTIFY ALL TRANSIT AGENCIES, TRASH COLLECTION AGENCY, AND EMERGENCY SERVICES OF THE PAVING SCHEDULE TO ALLOW COORDINATION.
- THE CONTRACTOR SHALL BE SOLELY RESPONSIBLE FOR ANY DAMAGES TO THE SITE OR SURROUNDING AREA AS A RESULT OF THE CONTRACTOR'S WORK OR OPERATIONS. EXISTING CURB, GUTTER AND OTHER IMPROVEMENTS THAT ARE DAMAGED BY THE CONTRACTOR SHALL BE REPLACED AT THE CONTRACTOR'S SOLE EXPENSE.
- THE CONTRACTOR SHALL RESTORE ALL PAVEMENT AND OTHER FACILITIES OUTSIDE OF THE SCOPE OF WORK AFFECTED BY CONSTRUCTION OPERATIONS TO PRE-CONSTRUCTION CONDITIONS AT NO ADDITIONAL COST TO THE DISTRICT.
- ALL STREET MONUMENTS AND OTHER PERMANENT MONUMENTS DISTURBED DURING CONSTRUCTION SHALL BE REPLACED BY THE CONTRACTOR, AT THE CONTRACTOR'S EXPENSE, BEFORE THE IMPROVEMENTS ARE ACCEPTED BY THE DISTRICT. REPLACEMENT SHALL BE MADE UNDER THE DIRECTION OF A DISTRICT APPROVED LAND SURVEYOR. THE CONTRACTOR SHALL PROVIDE A MINIMUM OF FIVE (5) WORKING DAYS NOTIFICATION FOR MONUMENT WORK.
- CONTRACTOR SHALL PROTECT EXISTING CATCH BASINS, CURB INLETS AND CURB DRAINS IN PLACE, UNLESS NOTED OTHERWISE.

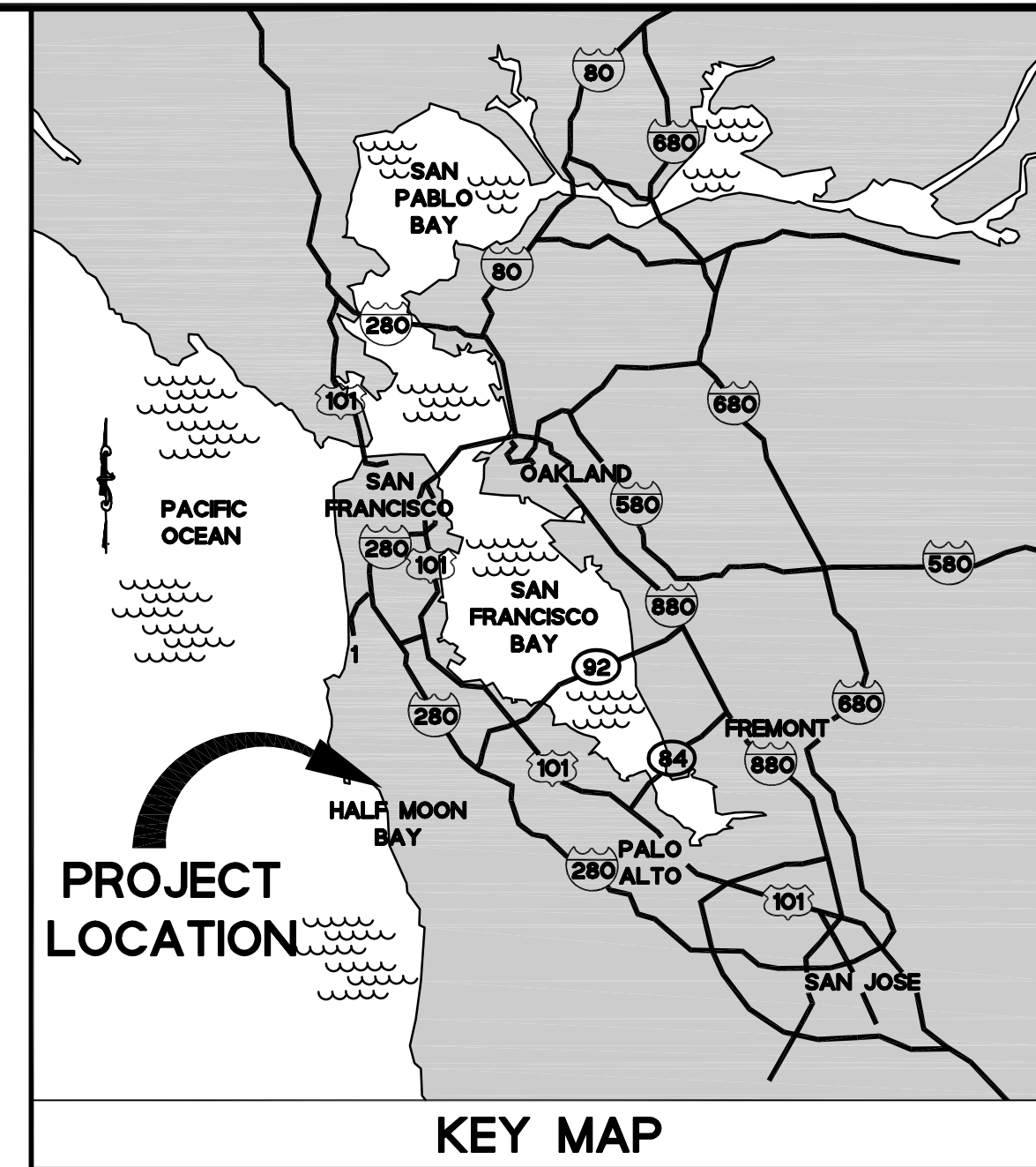

SHEET INDEX

- TITLE SHEET, GENERAL NOTES
- DEMOLITION PLAN
- IMPROVEMENTS PLAN (CONCRETE)
- IMPROVEMENTS PLAN (CONCRETE)
- IMPROVEMENTS PLAN (PAVEMENT)
- STRIPING/SIGNING PLAN
- STAGING PLAN
- ALTERNATE PARKING PLAN
- CONSTRUCTION DETAILS
- CONSTRUCTION DETAILS
- CONSTRUCTION DETAILS
- GENERAL DETAILS
- CONSTRUCTION BMPs

REVIEWED BY:

DATE: _____
SAN MATEO COUNTY HARBOR DISTRICT

CIVIL PLANS AND DETAILS PREPARED UNDER MY SUPERVISION

Ed Slintak DATE: 6/5/18
EDWARD T. SLINTAK R.C.E. 39925, EXPIRES 12/31/19

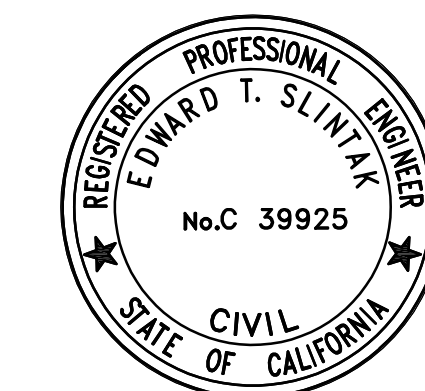

CONTRACTOR SHALL HAVE A VALID CLASS "A" CONTRACTOR'S LICENSE.

DESIGNED: ES DRAWN: AA, EB APPROVED: _____	REVISIONS NO. _____ DATE _____
PREPARED BY: CSG Consultants, Inc. 550 PILGRIM DRIVE FOSTER CITY, CA 94404 Phone: (650)522-2500 Fax: (650)522-2599	
PREPARED FOR: SAN MATEO COUNTY HARBOR DISTRICT HARBOR MASTER ONE JOHNSON PIER HALF MOON BAY, CA. 94019	
TITLE SHEET PILLAR POINT HARBOR RESTAURANT/STORE SIDEWALK EXPANSION PROJECT SAN MATEO COUNTY HARBOR DISTRICT	
SHEET 1 OF 13	DATE : 6/6/18 JOB# : 16.339

I:\SERVER2\Clients\DESIGN\16.339 - SMC - HMB - Pillar Point\2018-05-18 - BID SET\02_DEMOLITION PLAN.dwg (02_DEMOLITION) Plotted on: 06-05-18 3:25pm Plotted by: amifa

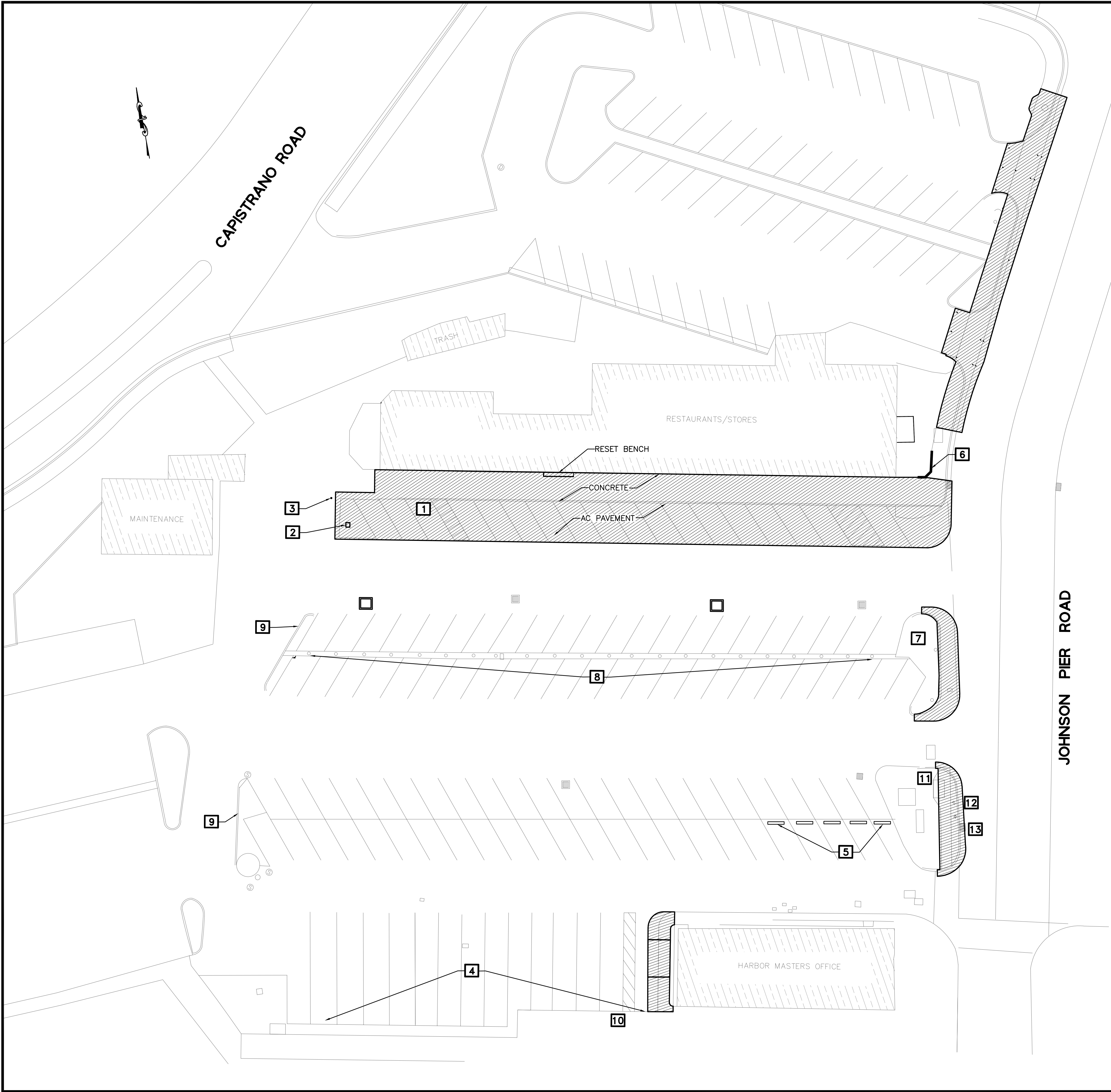

LEGEND

- 1** REMOVE (E) ELECTROLIER FOUNDATION 24"X24" TO 12" BELOW GRADE.
 - 2** REMOVE (E) SIGN POST AND CONCRETE BARREL. SALVAGE 2 SIGN PANELS.
 - 3** REMOVE (E) SIGN POST, SALVAGE SIGN PANEL.
 - 4** REMOVE (E) WHEEL STOPS.
 - 5** (E) WHEEL STOPS TO REMAIN.
 - 6** (E) BRICK WALL TO REMAIN.
 - 7** PROTECT (E) LANDSCAPE ITEMS.
 - 8** (E) SIGN POSTS TO REMAIN.
 - 9** (E) CURB/DIKE TO REMAIN.
 - 10** REMOVE (E) SIGN AND POST.
 - 11** PROTECT (E) PG&E VAULT.
 - 12** PROTECT (E) FIRE HYDRANT.
 - 13** PROTECT (E) DRAIN INLET.
- DEMOLITION LIMITS.

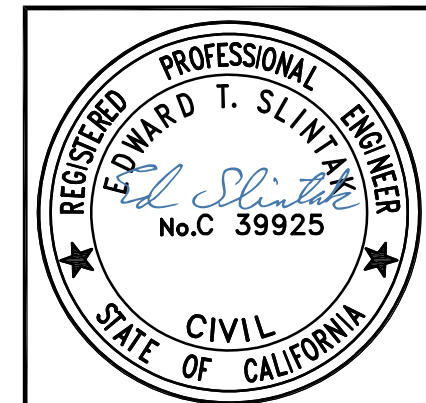
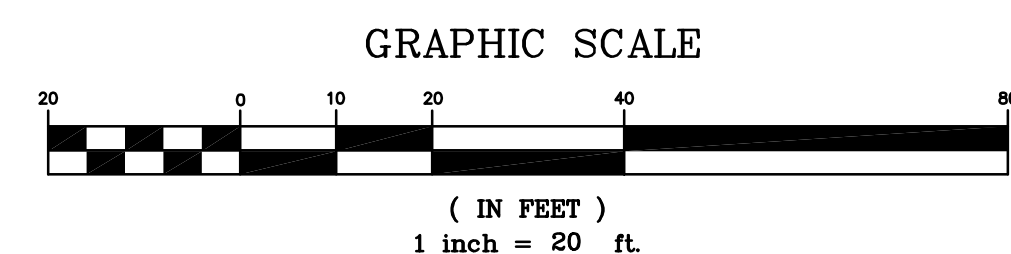

BID SET
6/6/18

<p>DESIGNED: ES</p> <p>DRAWN: AA, EB</p> <p>APPROVED: -</p>	<p>NO.</p> <p>REVISIONS</p> <p>DATE</p>
<p>PREPARED BY: CSG Consultants, Inc. 550 PILGRIM DRIVE FOSTER CITY, CA 94044 Phone: (650)522-2500 Fax: (650)522-2599</p>	
<p>PREPARED FOR: SAN MATEO COUNTY HARBOR DISTRICT HARBOR MASTER ONE JOHNSON PIER HALF MOON BAY, CA. 94019</p>	
<p>TITLE: DEMOLITION PLAN PILLAR POINT HARBOR RESTAURANT/STORE SIDEWALK EXPANSION PROJECT SAN MATEO COUNTY HARBOR DISTRICT</p>	
<p>SHEET 2 OF 13</p>	
<p>DATE : 6/6/18 JOB# : 16.339</p>	

I:\SERVERS\Clients\DESIGN\16.339 - SMC - HMB - Pillar Point\2018-05-18 - BID SET\03_04_IMPROVEMENTS PLAN.dwg (03_IMPROV) Plotted on: 06-05-18 4:41pm Plotted by: amtra

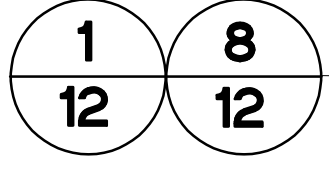
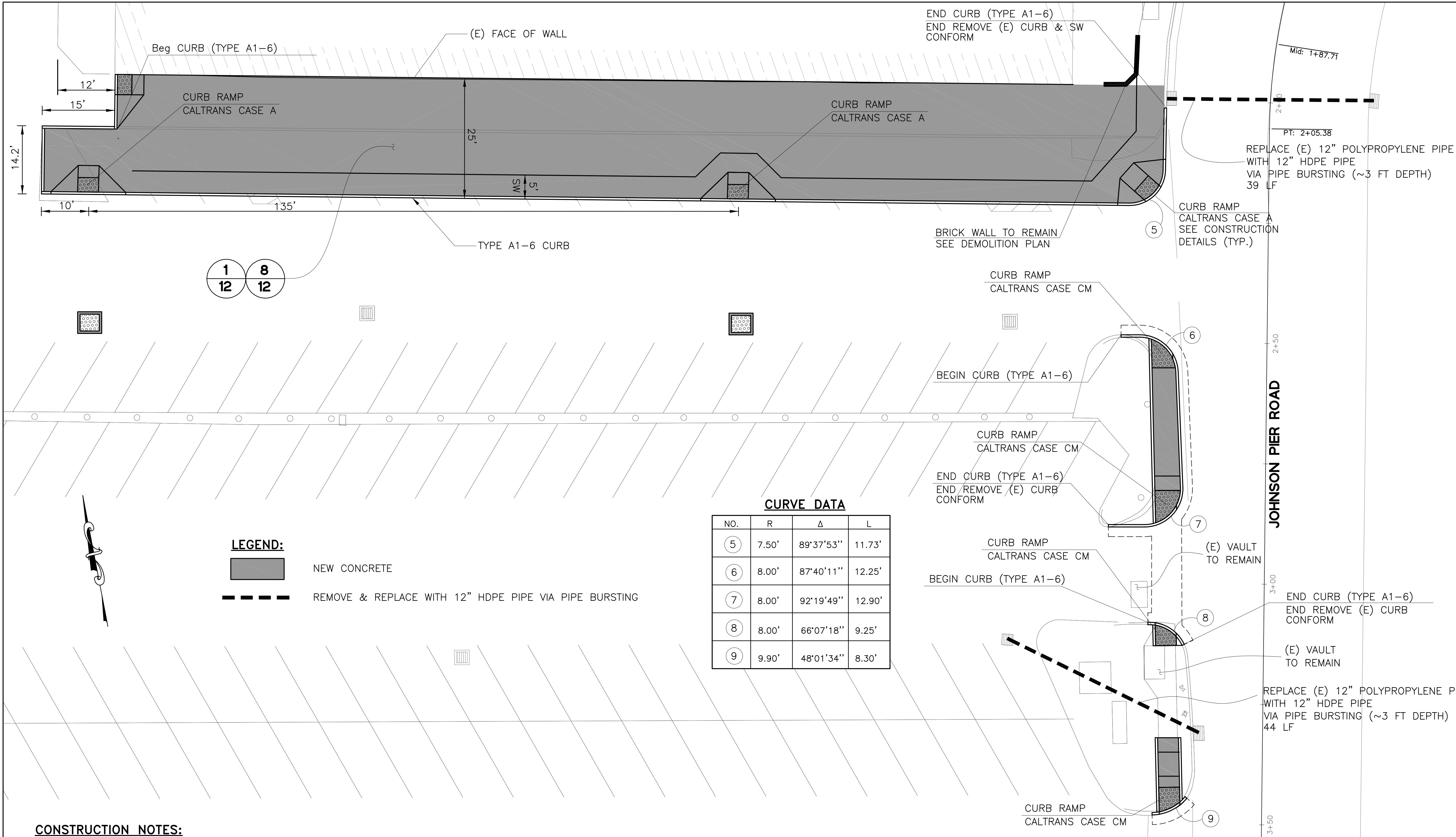

LEGEND:

- NEW CONCRETE
- REMOVE & REPLACE WITH 12" HDPE PIPE VIA PIPE BURSTING

CURVE DATA

NO.	R	Δ	L
5	7.50'	89°37'53"	11.73'
6	8.00'	87°40'11"	12.25'
7	8.00'	92°19'49"	12.90'
8	8.00'	66°07'18"	9.25'
9	9.90'	48°01'34"	8.30'

CONSTRUCTION NOTES:

1. CURB RAMPS TO BE ALIGNED WITH CROSSWALKS. REFERENCE 2015 REVISED STANDARD PLANS (RSPs) FOR CURB RAMPS (RSP A88A AND A88B).
2. REMOVE EXIST CONCRETE/PAVEMENT WHERE NEW CONCRETE IS SHOWN.
3. SAWCUT AND CONFORM ALL NEW CONCRETE ALONG EXISTING CONCRETE/PAVEMENT

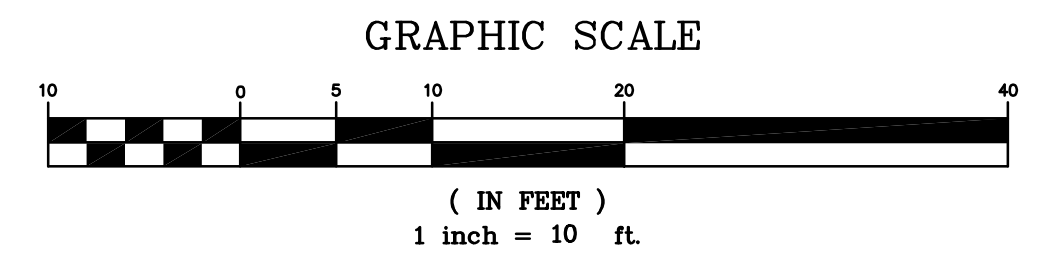

<p>DESIGNED: ES</p> <p>DRAWN: AA, EB</p> <p>APPROVED: -</p>	<p>NO. _____</p> <p>REVISIONS _____</p> <p>DATE _____</p>
<p>PREPARED BY: CSG Consultants, Inc.</p> <p>550 PILGRIM DRIVE FOSTER CITY, CA 94404 Phone: (650)522-2500 Fax: (650)522-2599</p>	
<p>PREPARED FOR: SAN MATEO COUNTY HARBOR DISTRICT HARBOR MASTER ONE JOHNSON PIER HALF MOON BAY, CA. 94019</p>	
<p>TITLE: IMPROVEMENT PLAN (CONCRETE) PILLAR POINT HARBOR RESTAURANT/STORE SIDEWALK EXPANSION PROJECT SAN MATEO COUNTY HARBOR DISTRICT</p>	
<p>SHEET 3 OF 13</p>	
<p>DATE: 6/6/18</p> <p>JOB#: 16.339</p>	

\\SERVER02\clients\DESIGN\16.339-SMC-HMB-Pillar Point\2018-05-18 - BID SET\03_04_IMPROVEMENTS_PLAN.dwg (04_IMPROV) Plotted on: 06-05-18 4:46pm Plotted by: amtra

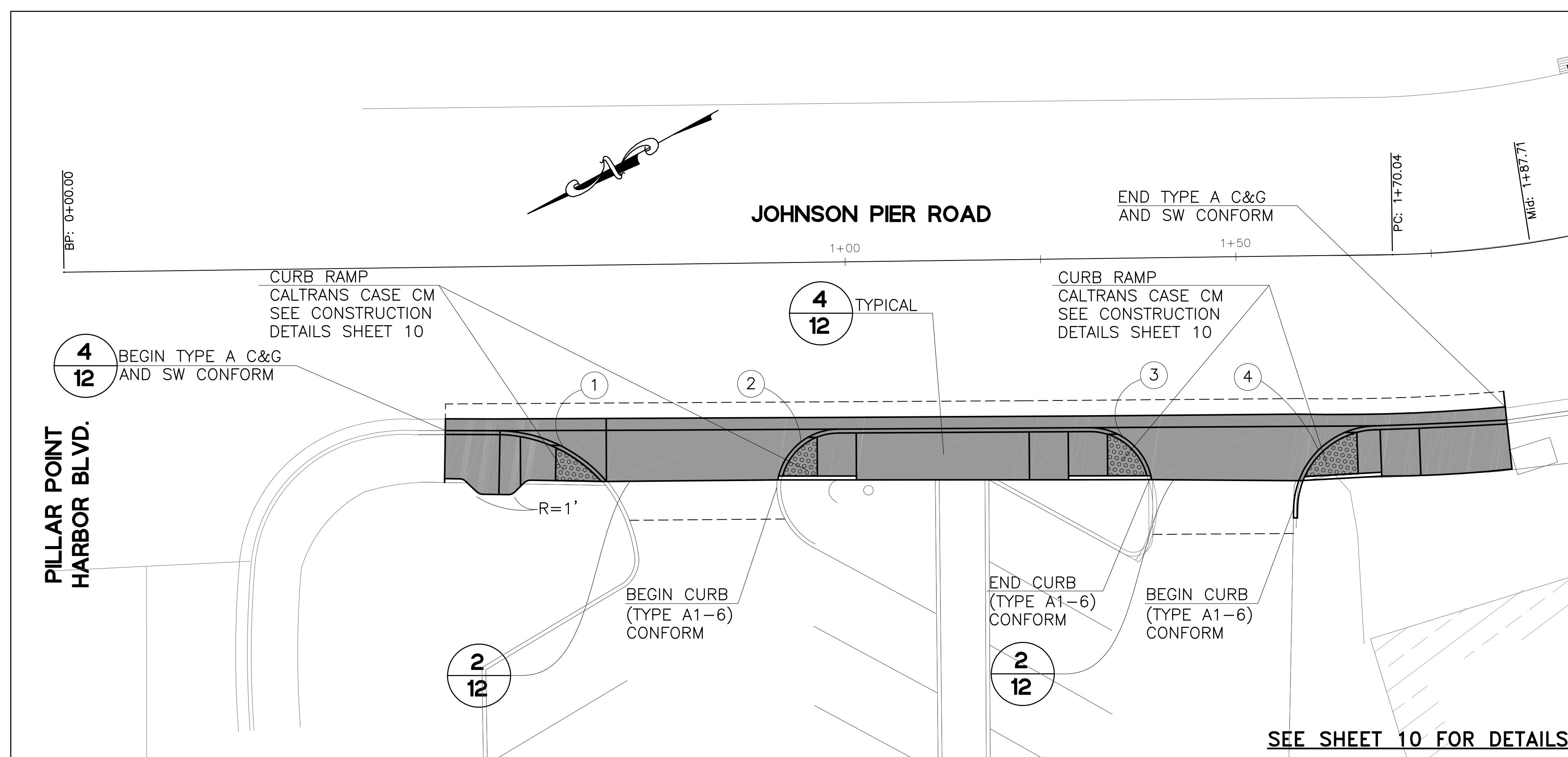

CONSTRUCTION NOTES:

1. CURB RAMPS TO BE ALIGNED WITH CROSSWALKS. REFERENCE 2015 REVISED STANDARD PLANS (RSPs) FOR CURB RAMPS (RSP A88A AND A88B).
2. REMOVE EXIST CONCRETE/PAVEMENT WHERE NEW CONCRETE IS SHOWN.
3. SAWCUT AND CONFORM ALL NEW CONCRETE ALONG EXSITING CONCRETE/PAVEMENT

CURVE DATA

NO.	R	Δ	L
①	18.50'	51°30'12"	16.63'
②	7.90'	86°30'26"	11.96'
③	8.00'	80°35'19"	11.25'
④	10.75'	87°20'08"	16.39'

LEGEND:

 NEW CONCRETE

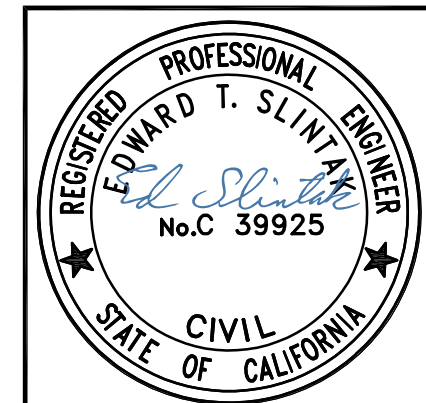
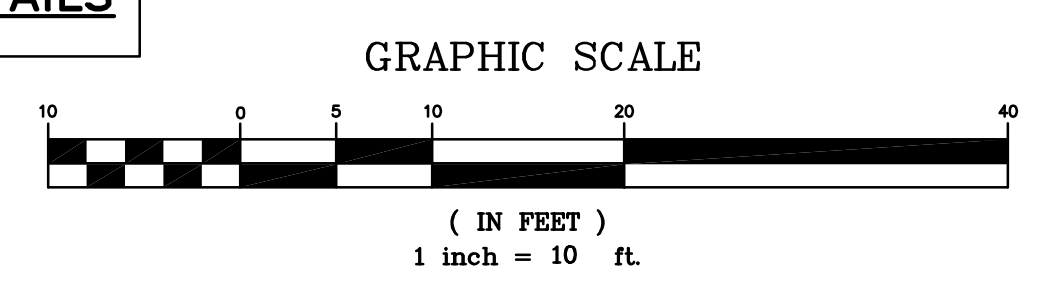

DESIGNED: ES	AA, EB	APPROVED: -	NO.	REVISIONS	DATE
PREPARED BY: CSG Consultants, Inc. 550 PILGRIM DRIVE FOSTER CITY, CA 94404 Phone: (650)522-2500 Fax: (650)522-2599					
PREPARED FOR: SAN MATEO COUNTY HARBOR DISTRICT HARBOR MASTER ONE JOHNSON PIER HALF MOON BAY, CA. 94019					
TITLE: IMPROVEMENT PLAN (CONCRETE) PILLAR POINT HARBOR RESTAURANT/STORE SIDEWALK EXPANSION PROJECT SAN MATEO COUNTY HARBOR DISTRICT					
SHEET 4 OF 13					
DATE: 6/6/18					
JOB#: 16.339					

I:\SERVER2\Clients\DESIGN\16.339 - SMC HMB Pillar Point\2018-05-18 - BID SET\05 IMPROVEMENT DIGOUT PLAN.dwg (05_PAVEMENT) Plotted on: 06-05-18 3:48pm Plotted by: amira

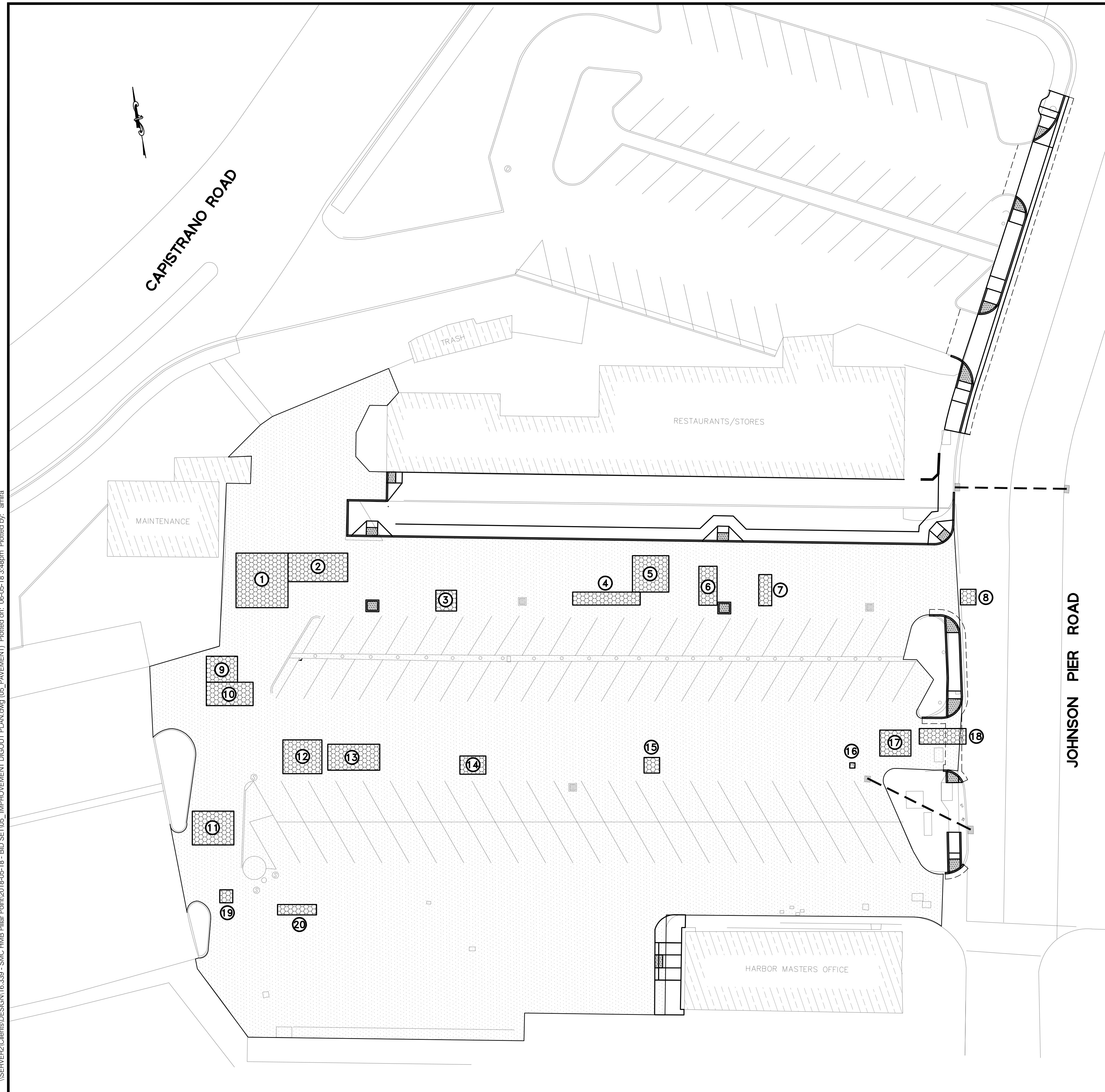

AC DIGOUTS TABLE (6-INCH)

AC DIGOUT NO.	BASE REPAIR LENGTH (FT)	BASE REPAIR WIDTH (FT)	BASE REPAIR AREA (SF)
1	21	20	420
2	23	11	253
3	8	8	64
4	26	5	130
5	14	14	196
6	7	15	105
7	5	12	60
8	6	6	36
9	12	10	120
10	18	9	162
11	13	16	208
12	13	15	195
13	20	10	200
14	10	7	70
15	6	6	36
16	2	2	4
17	10	12	120
18	6	18	108
19	5	5	25
20	15	4	60
TOTAL			2,572

RESURFACING QUANTITIES

SLURRY SEAL 5,700 SY

LEGEND

PAVEMENT REPAIR (DIGOUTS)

SLURRY SEAL

NOTES

- LOCATIONS OF AC DIGOUTS SHOWN ARE APPROXIMATE. CONTRACTOR SHALL MARK THE DIGOUT LOCATIONS IN THE FIELD TO BE APPROVED OR MODIFIED BY THE HARBOR DISTRICT PRIOR TO CONSTRUCTION.

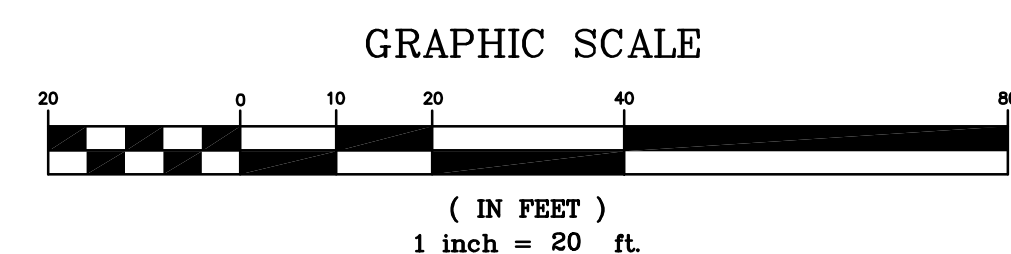

<p>DESIGNED BY: ES</p> <p>DRAWN: AA, EB</p> <p>APPROVED: -</p>	<p>NO.</p> <p>REVISIONS</p> <p>DATE</p>
<p>PREPARED BY: CSG Consultants, Inc. 550 PILGRIM DRIVE FOSTER CITY, CA 94404 Phone: (650)522-2500 Fax: (650)522-2599</p>	
<p>PREPARED FOR: SAN MATEO COUNTY HARBOR DISTRICT HARBOR MASTER ONE JOHNSON PIER HALF MOON BAY, CA. 94019</p>	
<p>TITLE: IMPROVEMENT PLAN (PAVEMENT) PILLAR POINT HARBOR RESTAURANT/STORE SIDEWALK EXPANSION PROJECT SAN MATEO COUNTY HARBOR DISTRICT</p>	
<p>SHEET 5 OF 13</p>	
<p>DATE : 6/6/18 BID SET 6/6/18 JOB# : 16.339</p>	

I:\SERVER2\Clients\DESIGN\16.339 - SMC HMB Pillar Point\2018-05-18 - BID SET\06 STRIPING PLAN.dwg (06 STRIPING) Plotted on: 06/05/18 3:53pm Plotted by: amira

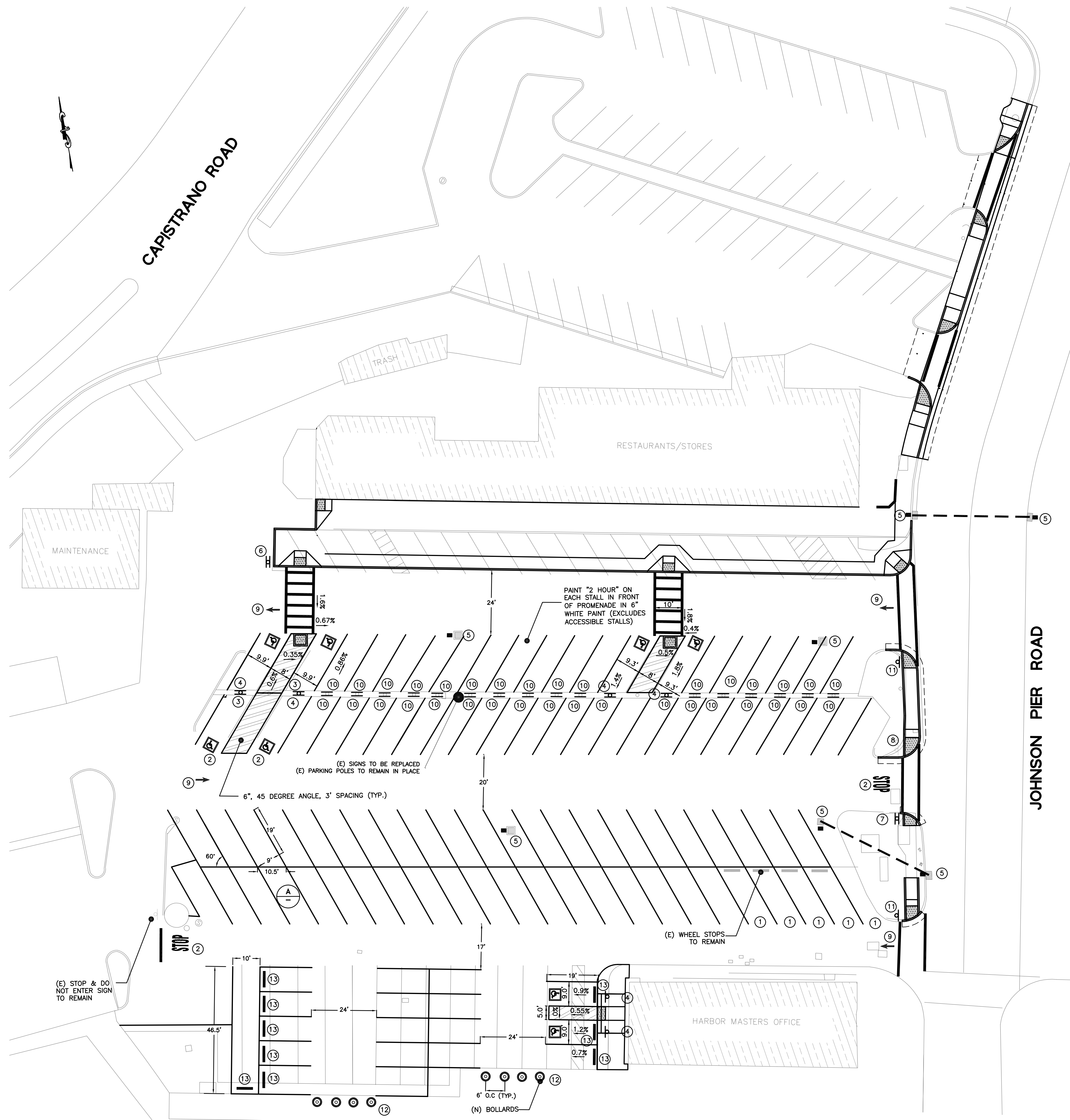

**PILLAR POINT HARBOR STRIPING
LEGEND AND QUANTITIES FOR SHEET 6:**

DESCRIPTION	LINETYPE / SYMBOL	QTY	UNIT
4" WHITE PAINT	—	3279	LF
12" WHITE CROSSWALK/LIMIT LINE	—	304	LF
6" WHITE STRIPE FOR LANDING ZONE	▨	175	LF
PAVEMENT LEGENDS	☐	284	SF
NEW PARKING POST & SIGN	⊥	10	EA
NEW PARKING SIGN ON (E) POST	—	34	EA
CONCRETE WHEEL STOPS	■	9	EA
DRAINS TO BAY MARKER AT INLETS	■	7	EA
BOLLARDS	●	8	EA

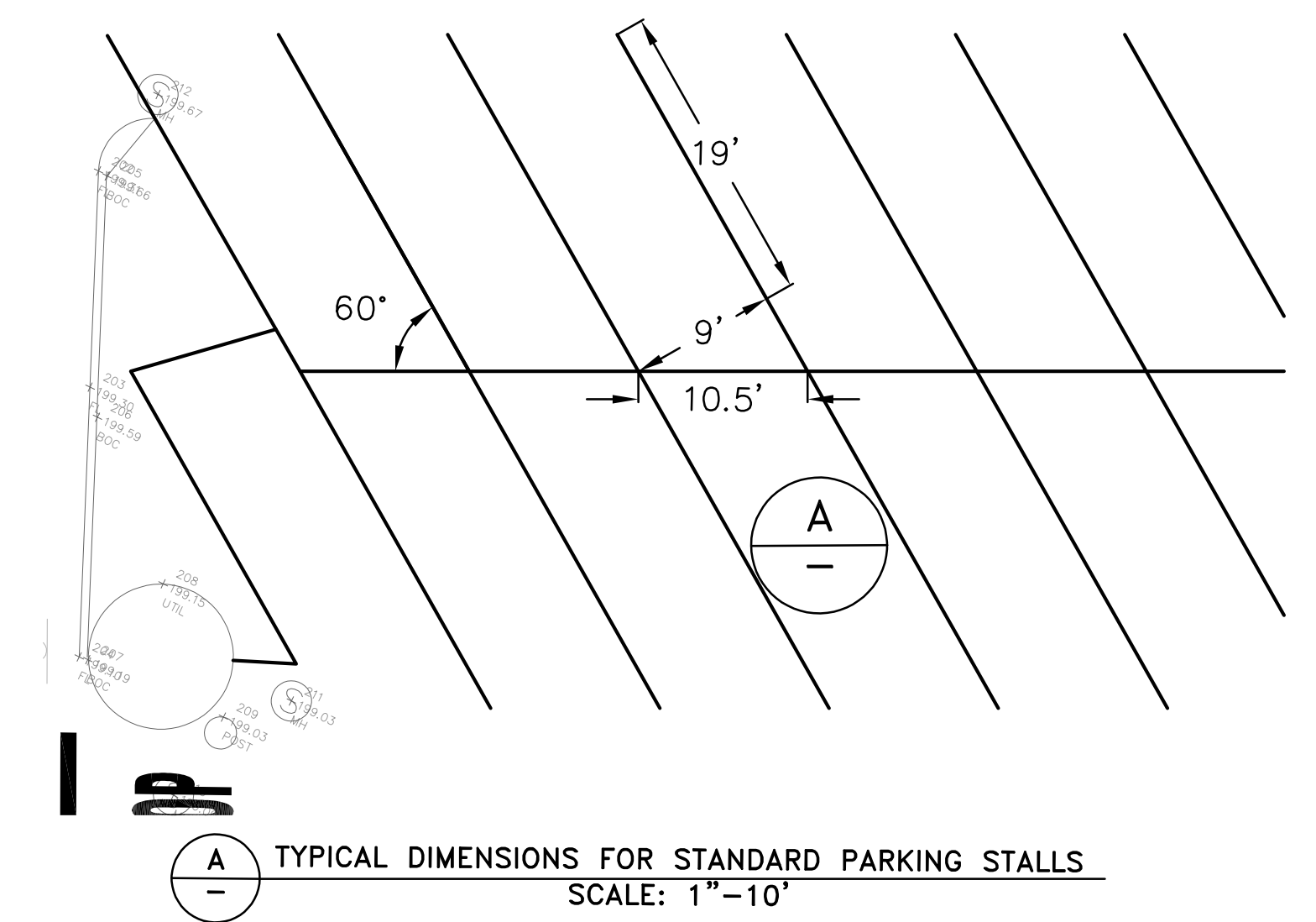

CONSTRUCTION NOTES:

- 1 PARKING STALLS TO BE LABELED AS "RESERVED HARBOR PATROL" IN 3-INCH WHITE LETTERS.
- 2 ALL PAVEMENT LEGENDS SHALL MEET CALTRANS 2015 STANDARD PLANS.
- 3 INSTALL R99 & R7-8B SIGN PER 2015 CALTRANS RSP A90A.
- 4 INSTALL R99C SIGN AND POST PER 2015 CALTRANS RSP A90A.
- 5 ALL INLETS SHALL INCLUDE A "NO DUMPING DRAINS TO BAY" IN 2" STENCIL.
- 6 INSTALL NEW R1-1 "STOP SIGN" & R5-1 "DO NOT ENTER" SIGN AND POST PER MUTCD & SHEET 10.
- 7 SALVAGE AND REINSTALL EXISTING R1-1 & R5-1 SIGN AND POST.
- 8 SALVAGE AND REINSTALL R5-1 SIGN AND POST.
- 9 TYPE 1 (10') ARROW PER CALTRANS 2015 STANDARD PLANS (TYP.).
- 10 INSTALL 2-HOUR PARKING LIMIT SIGN ON (E) PARKING POST. SEE DETAIL A ON SHEET 10.
- 11 INSTALL SIGN R100B SIGN PER 2015 CALTRANS RSP A90A.
- 12 INSTALL NEW BOLLARDS PER DETAIL 9 ON SHEET 12.
- 13 INSTALL NEW CONCRETE WHEEL STOPS.

NOTES:

1. DIMENSIONS SHOWN ARE MEASURED FROM CENTER OF STRIPE TO CENTER OF STRIPE, OR TO FACE OF CURB.
2. ALL STRIPING SHALL BE PAINT.
3. ALL EXISTING PARKING SIGNS SHALL BE PROTECTED IN PLACE UNLESS OTHERWISE NOTED ON PLANS.
4. ALL PARKING STALLS DESIGNATED AS ACCESSIBLE SHALL REQUIRE PARKING SIGN THAT MEETS ADA STANDARD.
5. PARKING STALL DIMENSIONS SHALL COMPLY WITH ADA STANDARD (9' X 19') STALLS UNLESS OTHERWISE NOTED ON PLANS OR APPROVED BY ENGINEER.

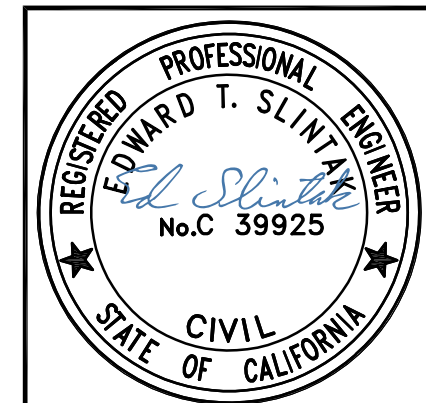
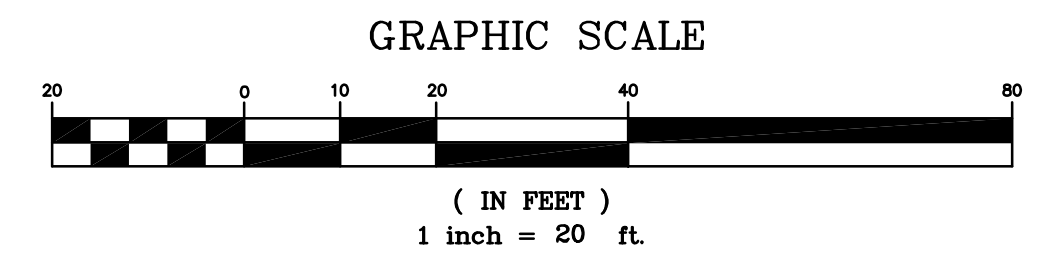

DESIGNED: ES
DRAWN: AA, EB
APPROVED: —

PREPARED BY:
CSG Consultants, Inc.
550 PILGRIM DRIVE
FOSTER CITY, CA 94404
Phone: (650)522-2500
Fax: (650)522-2599

PREPARED FOR:
SAN MATEO COUNTY HARBOR DISTRICT
HARBOR MASTER
ONE JOHNSON PIER
HALF MOON BAY, CA. 94019

TITLE:
STRIPING PLAN
PILLAR POINT HARBOR
RESTAURANT/STORE SIDEWALK EXPANSION PROJECT
SAN MATEO COUNTY HARBOR DISTRICT

SHEET 6
OF
13

DATE: 6/6/18
JOB#: 16.339

NO. REVISIONS DATE

STAGE CONSTRUCTION NOTES

- 2** COORDINATE WITH DISTRICT STAFF TO OPEN DRIVEWAY WHILE VALLEY GUTTER CONSTRUCTION IS ON - GOING.
- 3** CLOSE ONLY ONE DRIVEWAY AT A TIME DURING CONSTRUCTION.
- 4** MAINTAIN DRIVEWAY OPEN AT ALL TIMES, EXCEPT RESURFACING - PHASE 1.
- 5** MAINTAIN ACCESS TO BUSINESSES AT ALL TIMES, EXCEPT AS NOTED, OR AS APPROVED BY DISTRICT.
- 6** TEMPORARILY COVER (E) "DO NOT ENTER" SIGN.
- 7** SET TEMPORARY R40(CA) "TWO WAY TRAFFIC AHEAD" SIGN.
- 8** SET TEMPORARY R1-1 "STOP" SIGN.
- 9** STAY WITHIN CONFINES OF STAGING AREA AND STAGE EQUIPMENT TO ALLOW TRAFFIC TO ACCESS LOT A3.
- 10** SEE SHEET 8 FOR ALTERNATE PARKING PLAN.
- 11** ONE TRAVEL LANE SHALL BE AVAILABLE AT ALL TIMES. PROVIDE TRAFFIC CONTROL AS NEEDED.

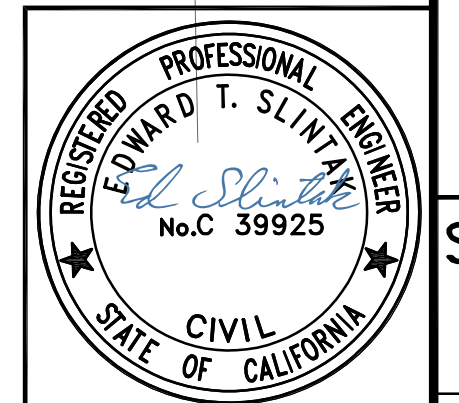
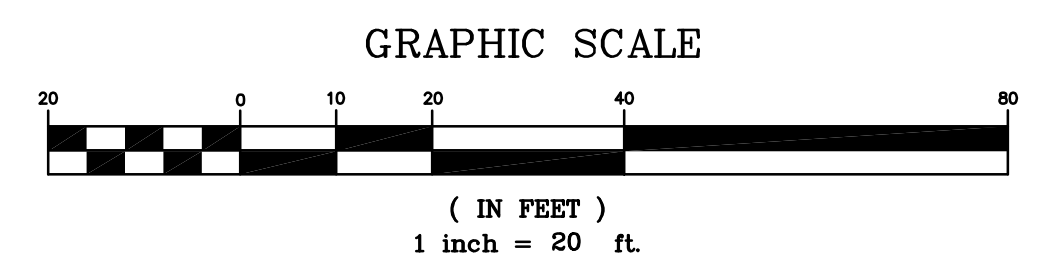
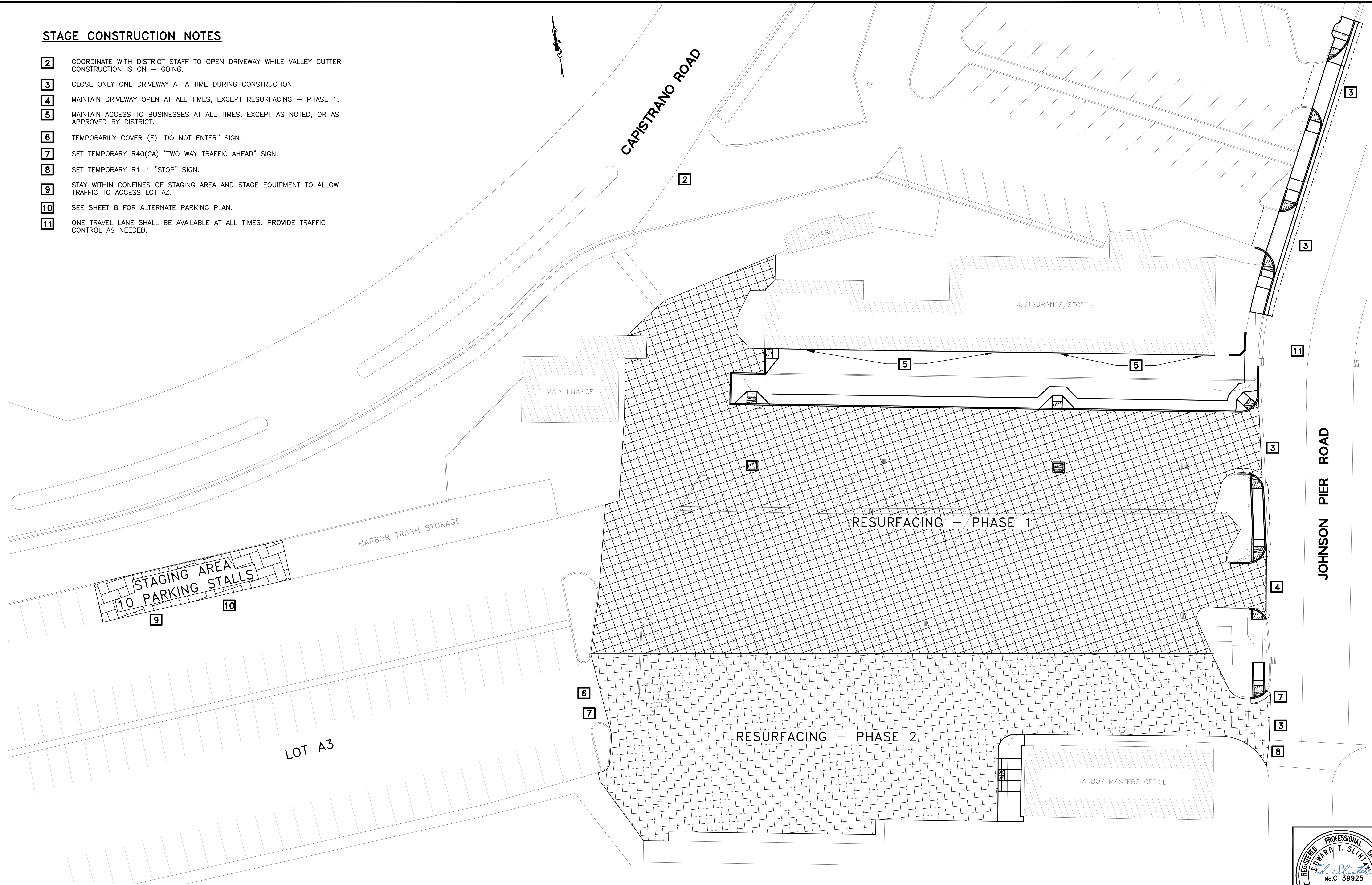

<p>DESIGNED: ES</p> <p>DRAWN: AA, EB</p> <p>APPROVED: _____</p>	<p>NO. _____</p> <p>REVISIONS _____</p> <p>DATE _____</p>
<p>PREPARED BY:</p> <p>CSG Consultants, Inc.</p> <p>550 PILGRIM DRIVE FOSTER CITY, CA 94404 Phone: (650)522-2500 Fax: (650)522-2599</p>	
<p>PREPARED FOR:</p> <p>SAN MATEO COUNTY HARBOR DISTRICT HARBOR MASTER ONE JOHNSON PIER HALF MOON BAY, CA. 94019</p>	
<p>TITLE:</p> <p>STAGING PLAN</p> <p>PILLAR POINT HARBOR RESTAURANT/STORE SIDEWALK EXPANSION PROJECT SAN MATEO COUNTY HARBOR DISTRICT</p>	
<p>SHEET 7</p> <p>OF</p> <p>13</p>	
<p>DATE : 6/6/18</p> <p>JOB# : 16.339</p>	

I:\SERVER2\Clients\DESIGN\16.339 - SMC - HMB - Pillar Point\2018-05-18 - BID SET\07_STAGING PLAN.dwg (07_STAGING) Plotted on: 06-05-18 3:59pm Plotted by: amira

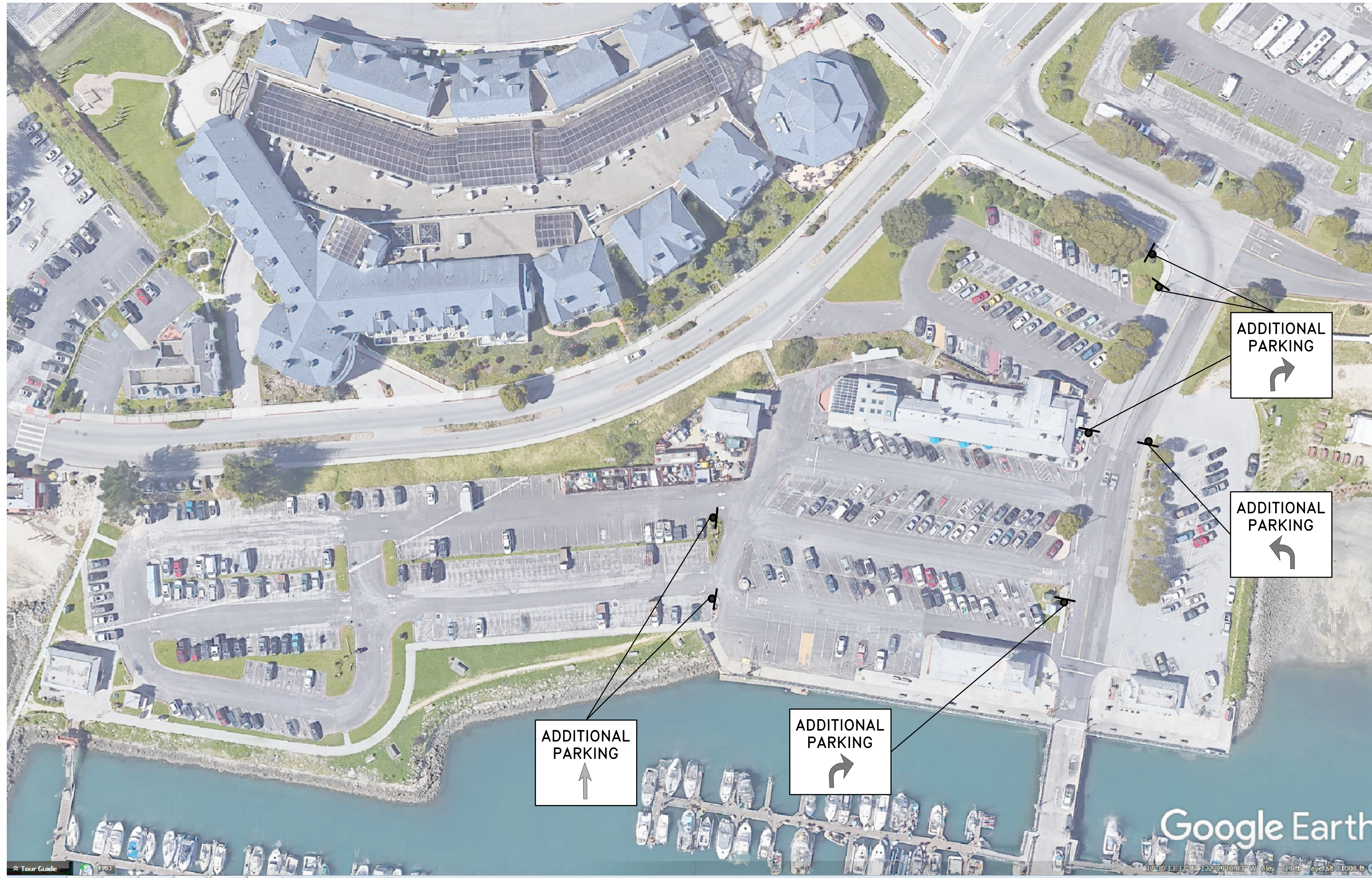

ADDITIONAL
PARKING
↑

ADDITIONAL
PARKING
↻

ADDITIONAL
PARKING
↻

ADDITIONAL
PARKING
↻

GENERAL NOTES

1. TEMPORARY SIGNS SHALL BE 30" X 30" AND SHALL BE ATTACHED TO WOODEN POSTS OR TEMPORARY BARRICADES.
2. ANY REVISIONS TO THIS PLAN SHALL BE APPROVED BY ENGINEER.
3. CONTRACTOR SHALL FOLLOW GUIDELINES ON STAGING PLAN TO ENSURE AMPLE PARKING IS AVAILABLE.
4. ALL SIGNS ON THIS SHEET ARE TO BE USED AS TEMPORARY SIGNS DURING CONSTRUCTION.

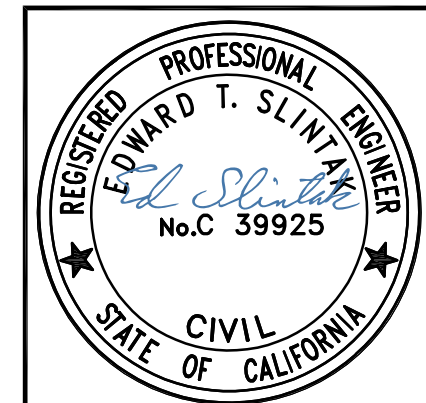

BID SET
6/6/18

DATE : 6/6/18
JOB# : 16.339

TITLE:
ALTERNATE PARKING PLAN
PILLAR POINT HARBOR
RESTAURANT/STORE SIDEWALK EXPANSION PROJECT
SAN MATEO COUNTY HARBOR DISTRICT

PREPARED FOR:
SAN MATEO COUNTY HARBOR DISTRICT
HARBOR MASTER
ONE JOHNSON PIER
HALF MOON BAY, CA. 94019



PREPARED BY:
CSG Consultants, Inc.
550 PILGRIM DRIVE
FOSTER CITY, CA 94044
Phone: (650)522-2500
Fax: (650)522-2599

DESIGNED: ES
DRAWN: AA, EB
APPROVED: -

NO.	REVISIONS	DATE

I:\SERVERS\Clients\DESIGN\16.339 - SMC - HMB - Pillar Point\2018-05-18 - BID SET\08 - ALTERNATE PARKING.dwg (8) Plotted on: 06-04-18 11:08am Plotted by: amira

BENCHMARKS:

THE BASIS OF ELEVATIONS FOR THIS SURVEY ARE DESIGNATED AS (MAG-NAIL & SHINER IN AC) BENCHMARKS SHOWN ON CONSTRUCTION DETAILS SHEETS # 9, 10, AND 11. POINTS NUMBER CP1, CP2, CP4 & CP5.

JOHNSON PIER ROAD

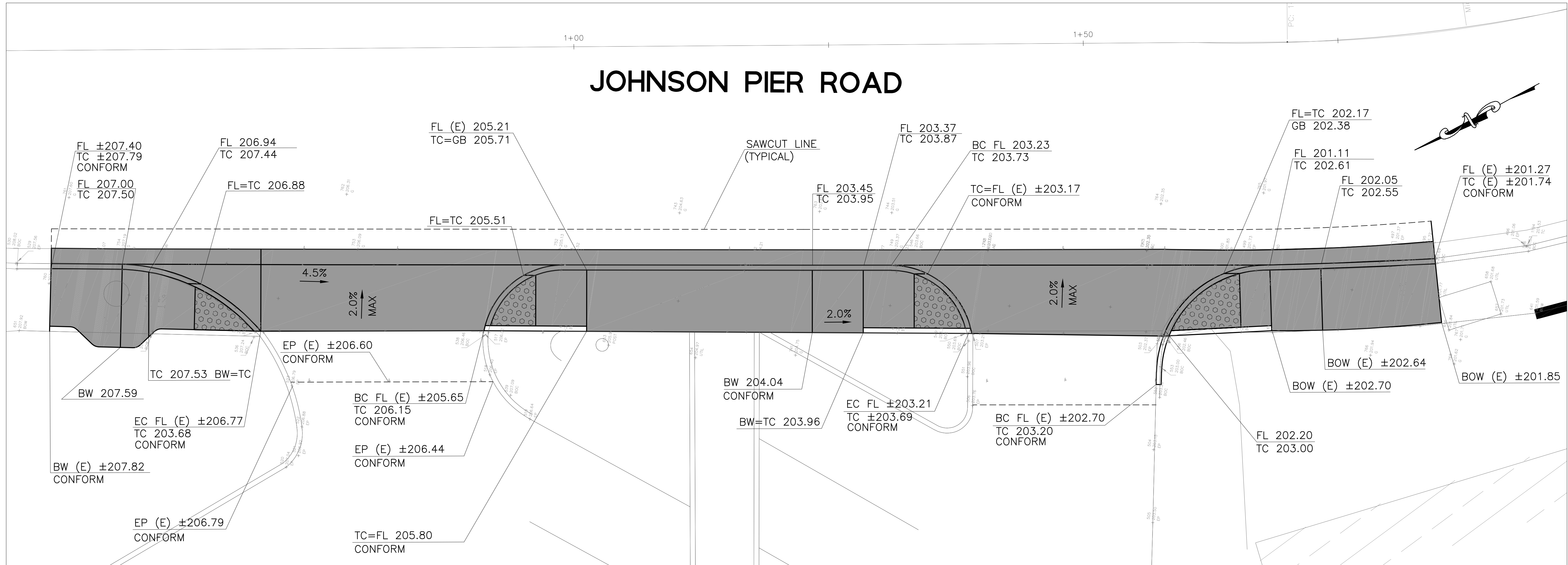

CAPISTRANO ROAD

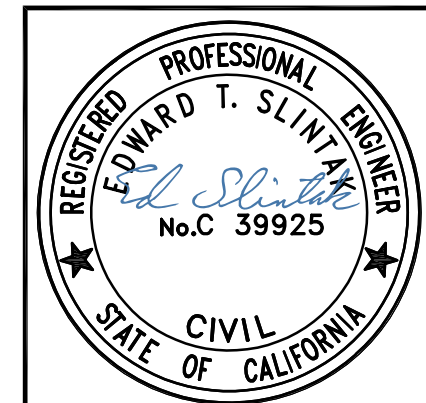
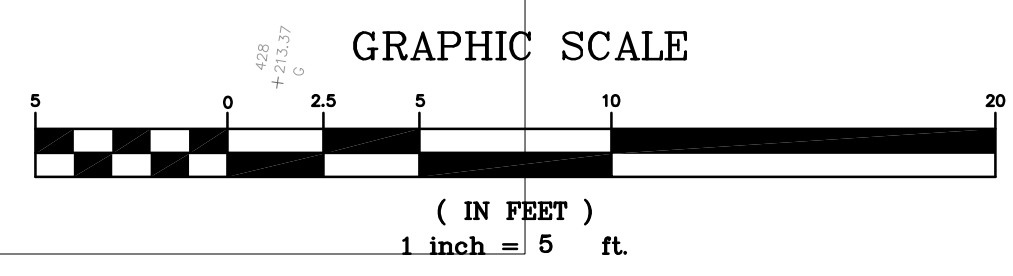
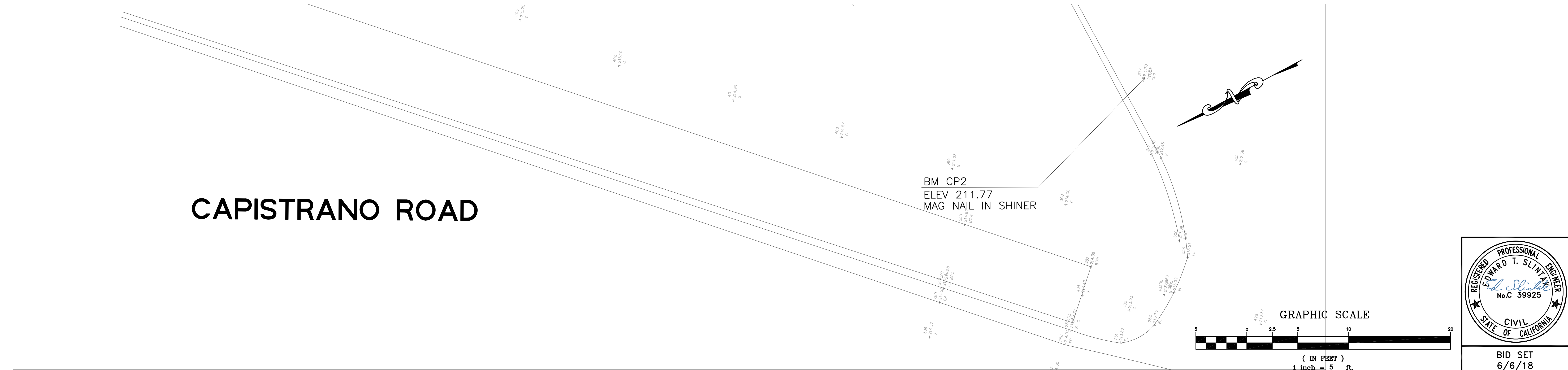

DESIGNED: ES	NO.	REVISIONS	DATE
DRAWN: AA, EB			
APPROVED:			
PREPARED BY: CSG Consultants, Inc. 550 PILGRIM DRIVE FOSTER CITY, CA 94404 Phone: (650)522-2500 Fax: (650)522-2599			
PREPARED FOR: SAN MATEO COUNTY HARBOR DISTRICT HARBOR MASTER ONE JOHNSON PIER HALF MOON BAY, CA. 94019			
TITLE: CONSTRUCTION DETAILS PILLAR POINT HARBOR RESTAURANT/STORE SIDEWALK EXPANSION PROJECT SAN MATEO COUNTY HARBOR DISTRICT			
SHEET 9 OF 13			
DATE : 6/6/18 JOB# : 16.339			

I:\SERVER2\Clients\DESIGN\16.339 - SMC - HMB - Pillar Point\2018-05-18 - BID SET\09_10_CONSTRUCTION DETAILS.dwg (09_Curb Ramps 1) Plotted on: 06-05-18 3:09pm Plotted by: amira

I:\SERVER2\Clients\DESIGN\16.339 - SMC - HMB - Pillar Point\2018-05-18 - BID SET\09_10_CONSTRUCTION_DETAILS.dwg (10_Curb Ramps.2) Plotted on: 06-05-18 4:57pm Plotted by: amira

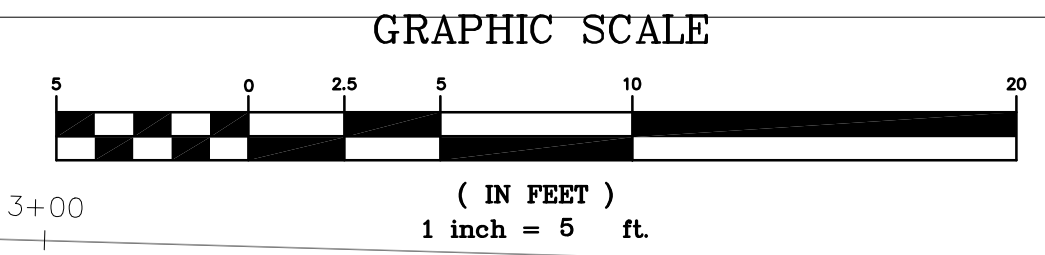
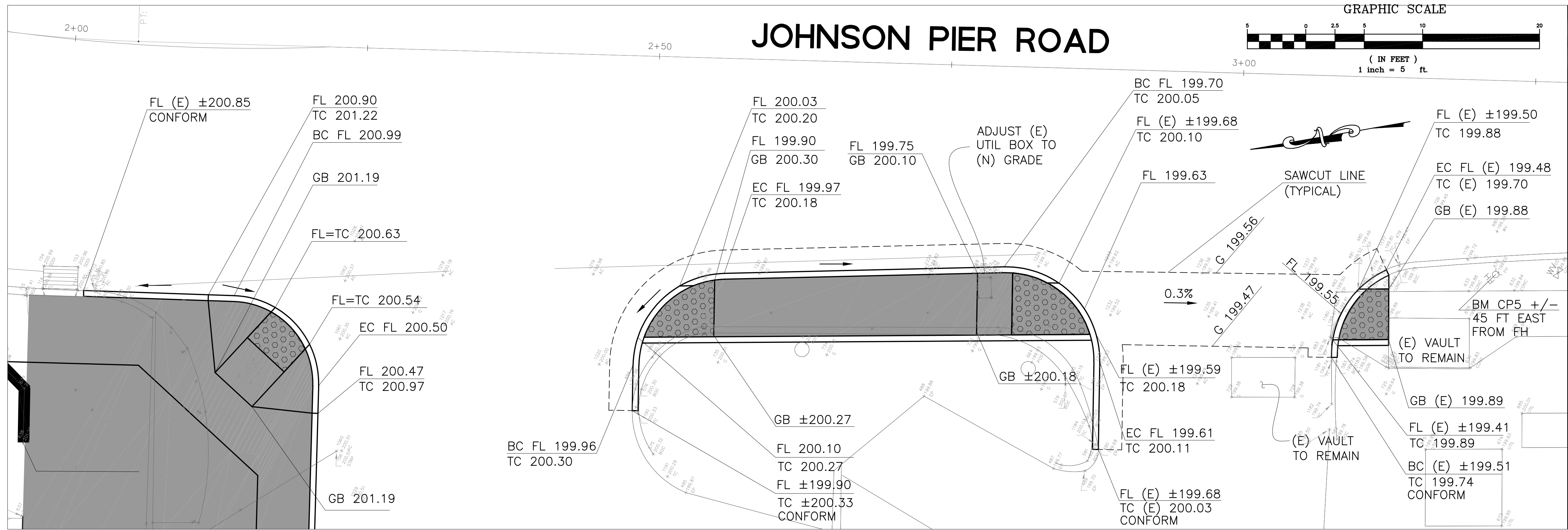

MATCHLINE - SEE BELOW

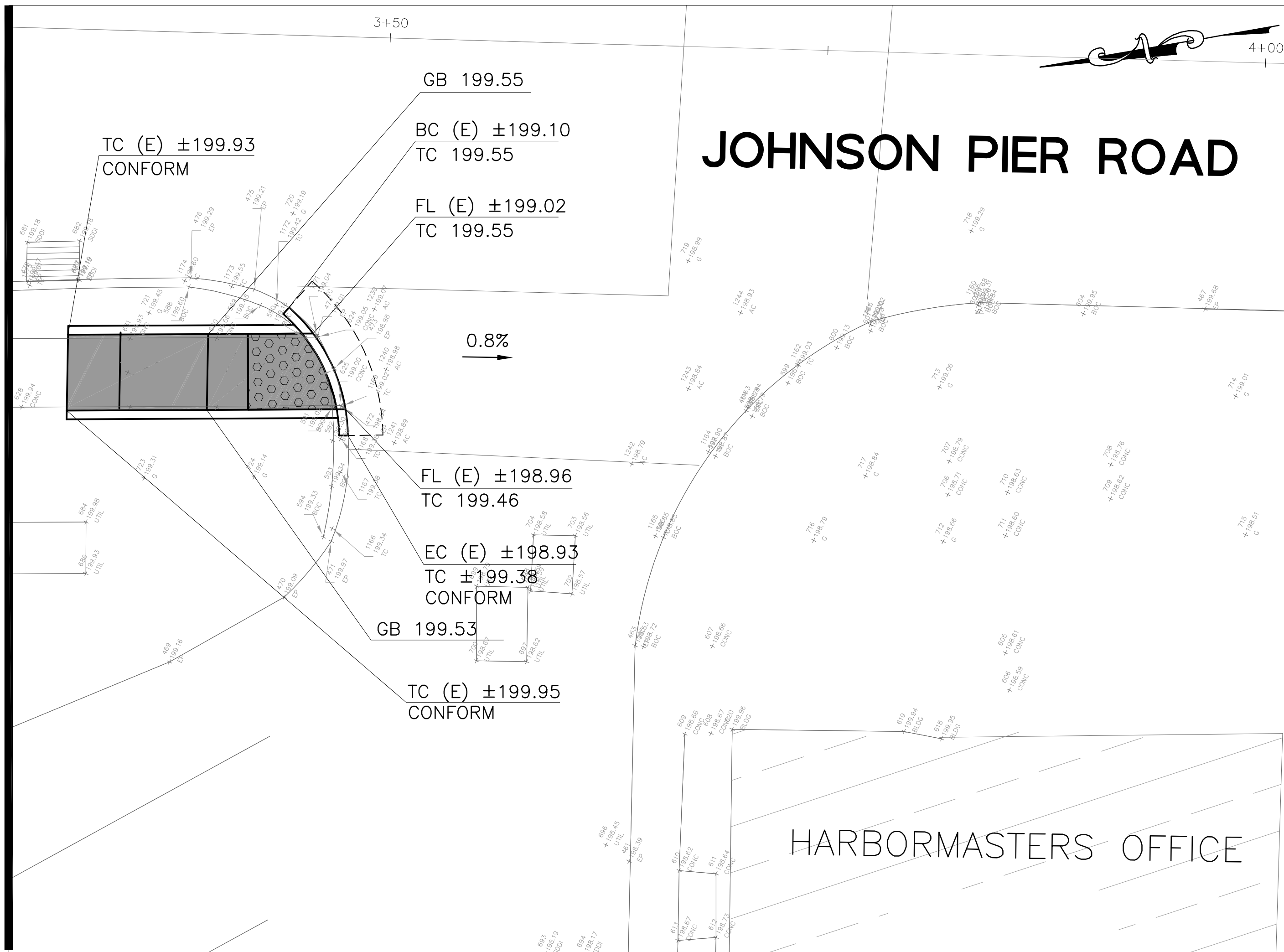

MATCHLINE - SEE ABOVE

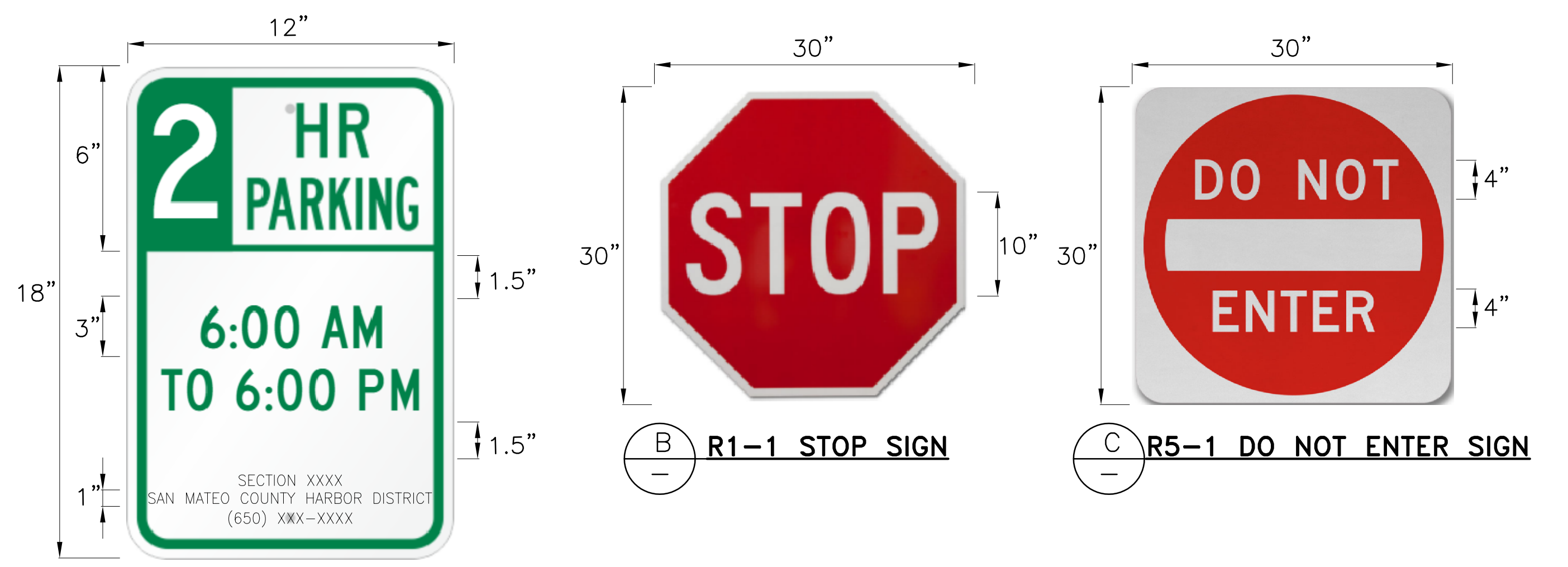

- CONSTRUCTION NOTES:**
- NEW SIGNS ARE TO BE MOUNTED ON EXISTING POLES.
 - CONTRACTOR SHALL WORK WITH SAN MATEO HARBOR DISTRICT TO DETERMINE CODES OF COMPLIANCE REQUIRED FOR PARKING SIGNS.
 - ANY CHANGES TO PARKING SIGN SHALL BE APPROVED BY HARBOR DISTRICT.

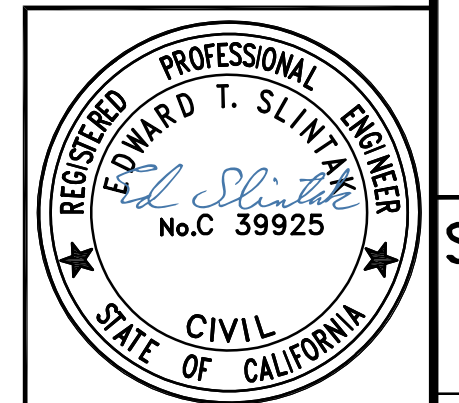
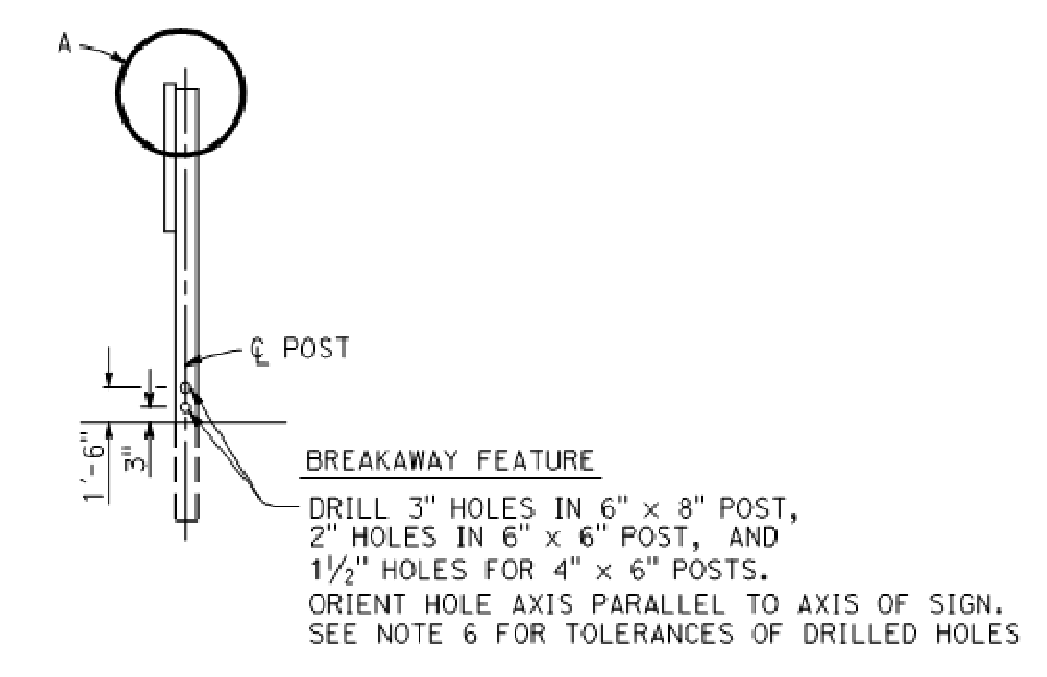

DESIGNED: ES	DRAWN: AA, EB	APPROVED:	NO.	REVISIONS	DATE
PREPARED BY: CSG Consultants, Inc. 550 PILGRIM DRIVE FOSTER CITY, CA 94404 Phone: (650)522-2500 Fax: (650)522-2599					
PREPARED FOR: SAN MATEO COUNTY HARBOR DISTRICT HARBOR MASTER ONE JOHNSON PIER HALF MOON BAY, CA. 94019					
CONSTRUCTION DETAILS PILLAR POINT HARBOR RESTAURANT/STORE SIDEWALK EXPANSION PROJECT SAN MATEO COUNTY HARBOR DISTRICT					
TITLE:			SHEET 10 OF 13		
BID SET 6/6/18			DATE: 6/6/18 JOB#: 16.339		

I:\SERVER2\Clients\DESIGN\16.339 - SMC - HMB - Pillar Point\2018-05-18 - BID SET\11_CONSTRUCTION DETAILS.dwg (11_CONSTRUCTION DETAILS). Plotted on: 06-05-18 4:55pm. Plotted by: amira

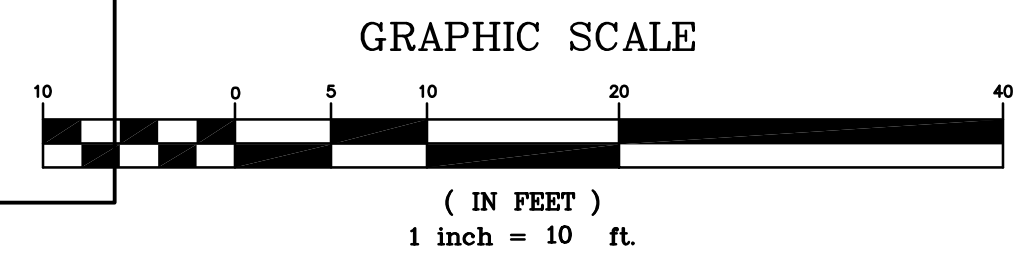
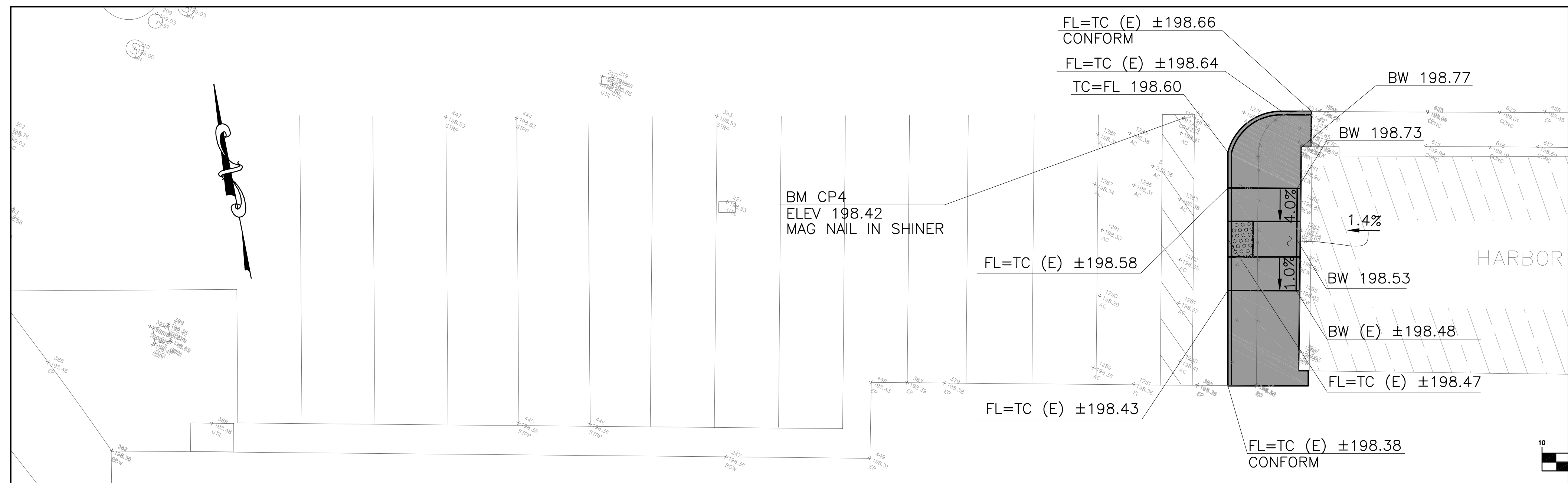
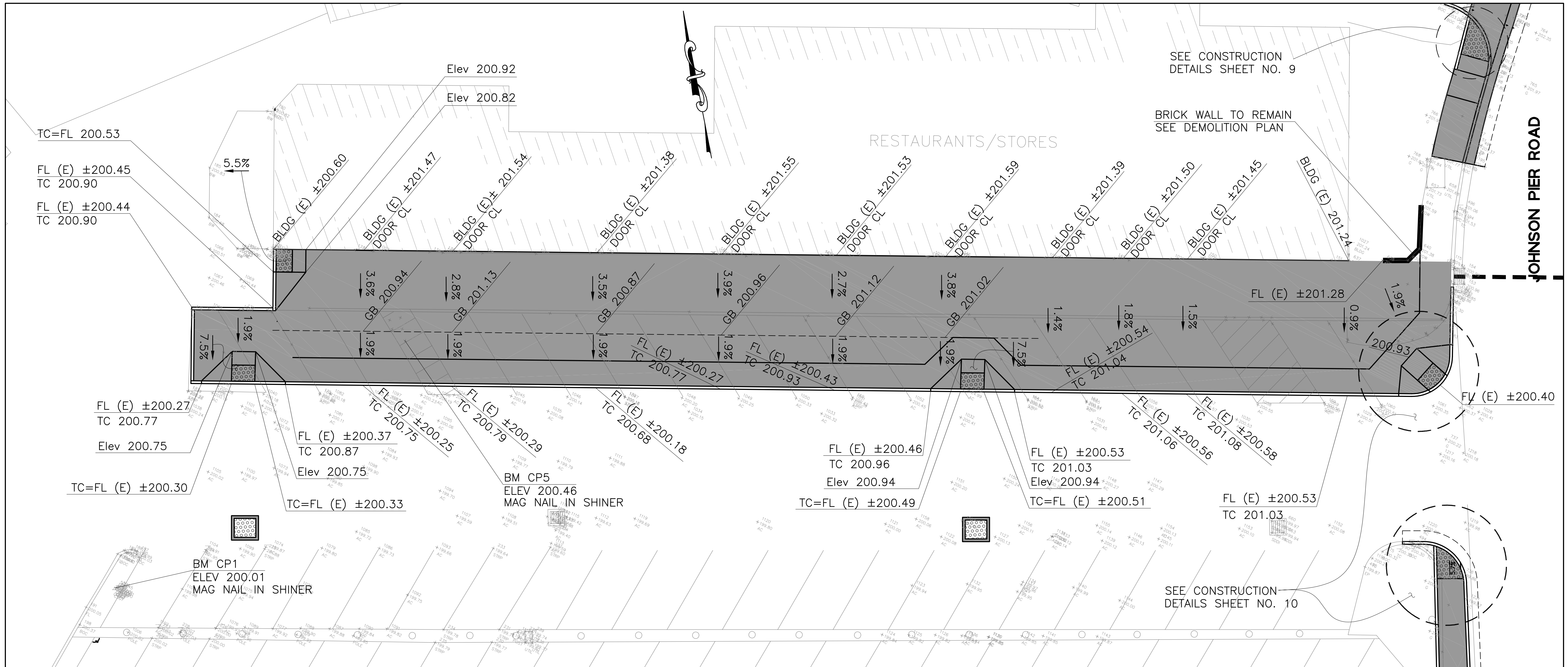

DESIGNED: ES	NO.	REVISIONS	DATE
DRAWN: AA, EB			
APPROVED:			
PREPARED BY: CSG Consultants, Inc. 550 PILGRIM DRIVE FOSTER CITY, CA 94404 Phone: (650)522-2500 Fax: (650)522-2599			
PREPARED FOR: SAN MATEO COUNTY HARBOR DISTRICT HARBOR MASTER ONE JOHNSON PIER HALF MOON BAY, CA. 94019			
TITLE: CONSTRUCTION DETAILS PILLAR POINT HARBOR RESTAURANT/STORE SIDEWALK EXPANSION PROJECT SAN MATEO COUNTY HARBOR DISTRICT			
SHEET 11		DATE: 6/6/18	
OF 13		JOB#: 16.339	

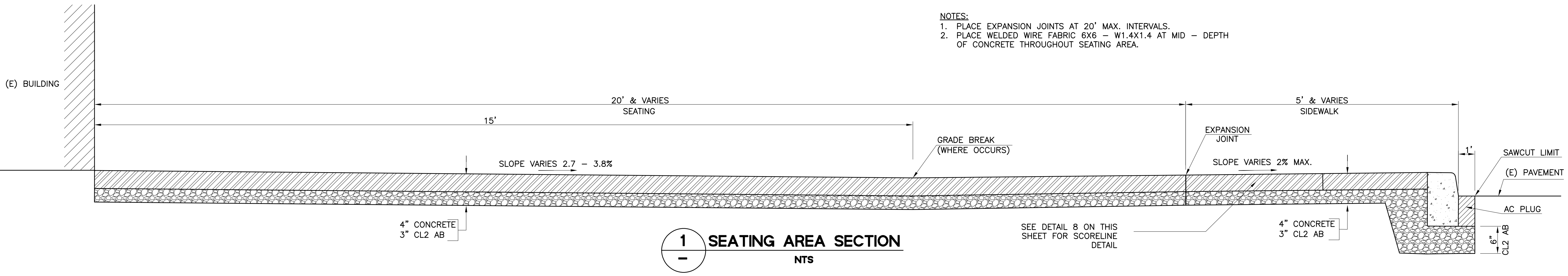

1 SEATING AREA SECTION
NTS

NOTES:
1. PLACE EXPANSION JOINTS AT 20' MAX. INTERVALS.
2. PLACE WELDED WIRE FABRIC 6X6 - W1.4X1.4 AT MID - DEPTH OF CONCRETE THROUGHOUT SEATING AREA.

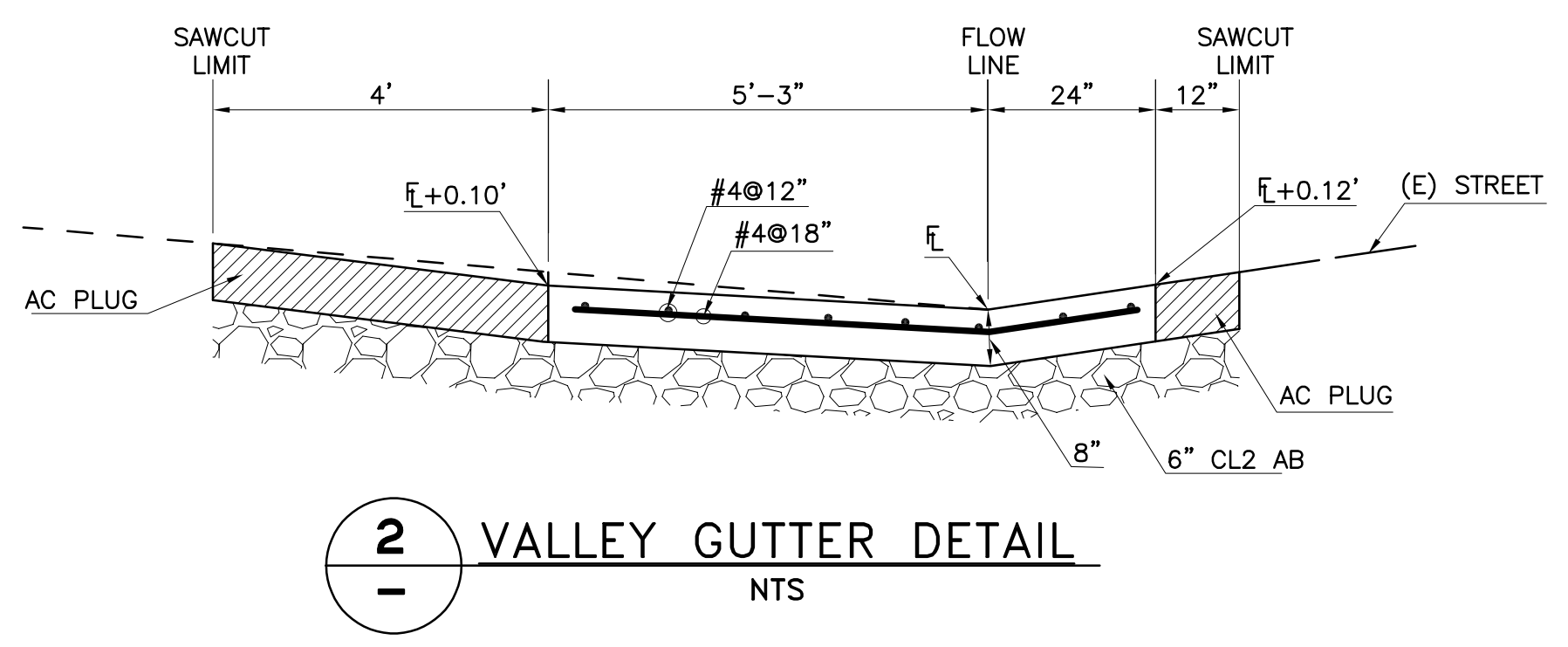

2 VALLEY GUTTER DETAIL
NTS

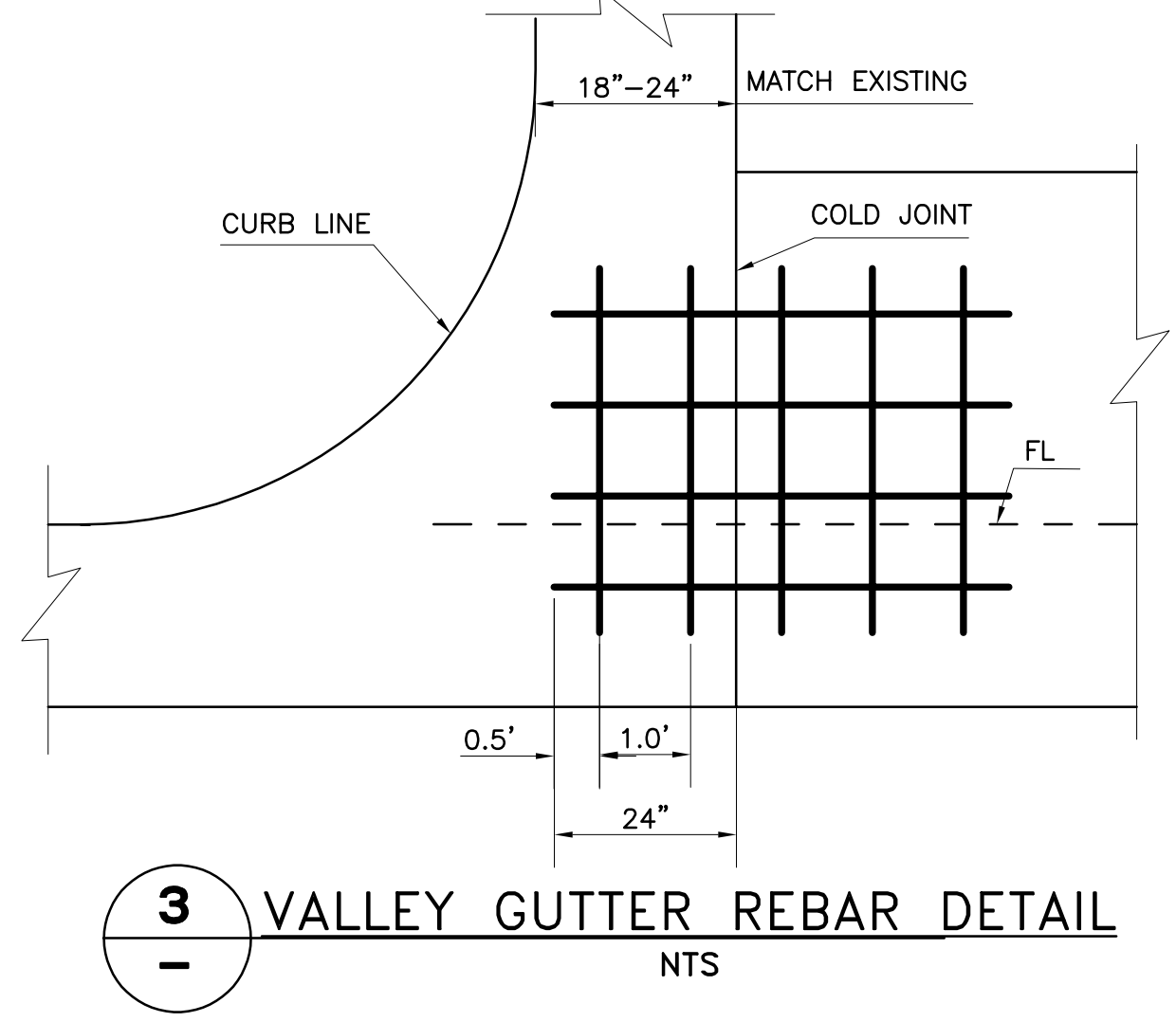

3 VALLEY GUTTER REBAR DETAIL
NTS

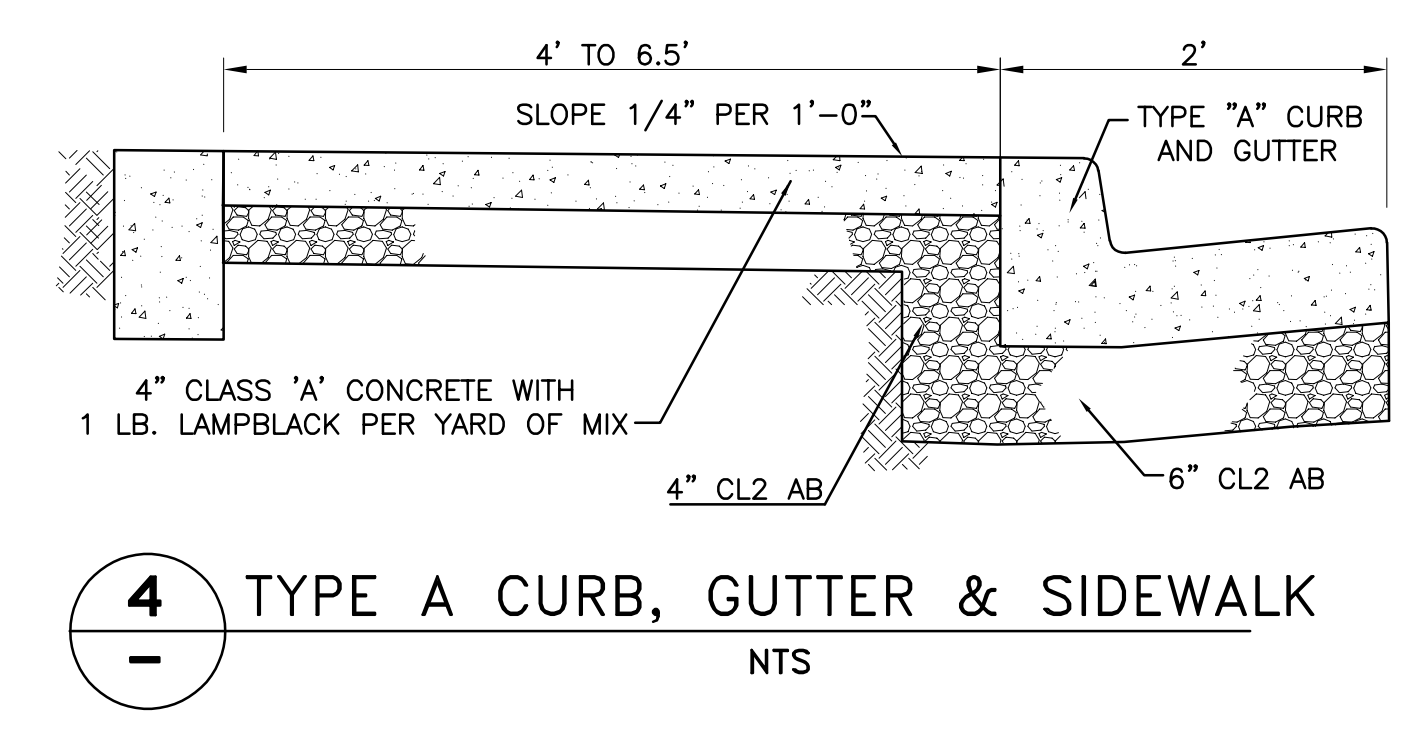

4 TYPE A CURB, GUTTER & SIDEWALK
NTS

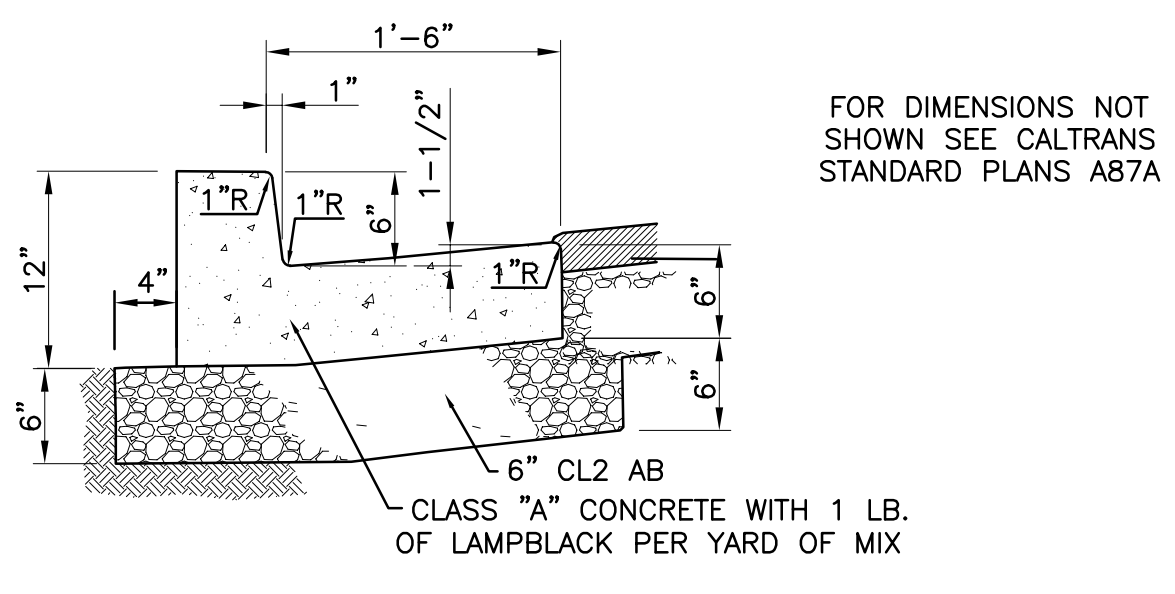

5 CURB AND GUTTER TYPE A2-6 (MOD.)
NTS

FOR DIMENSIONS NOT SHOWN SEE CALTRANS STANDARD PLANS A87A

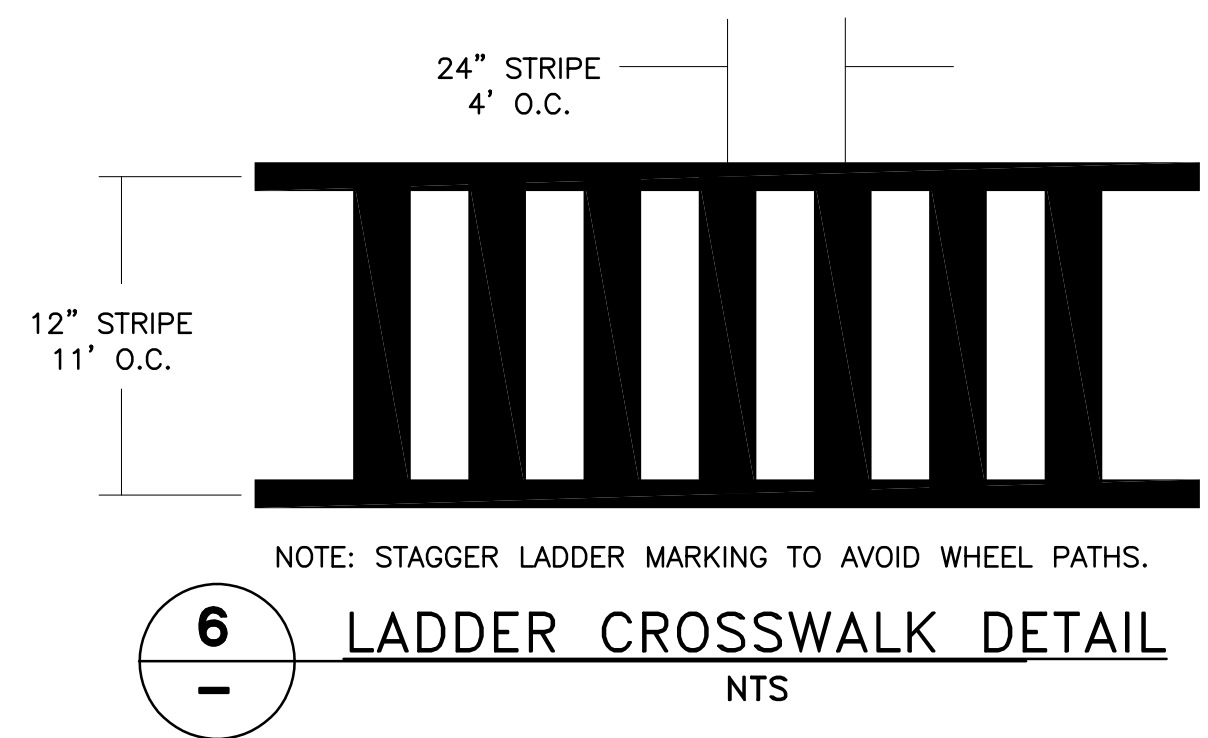

6 LADDER CROSSWALK DETAIL
NTS

NOTE: STAGGER LADDER MARKING TO AVOID WHEEL PATHS.

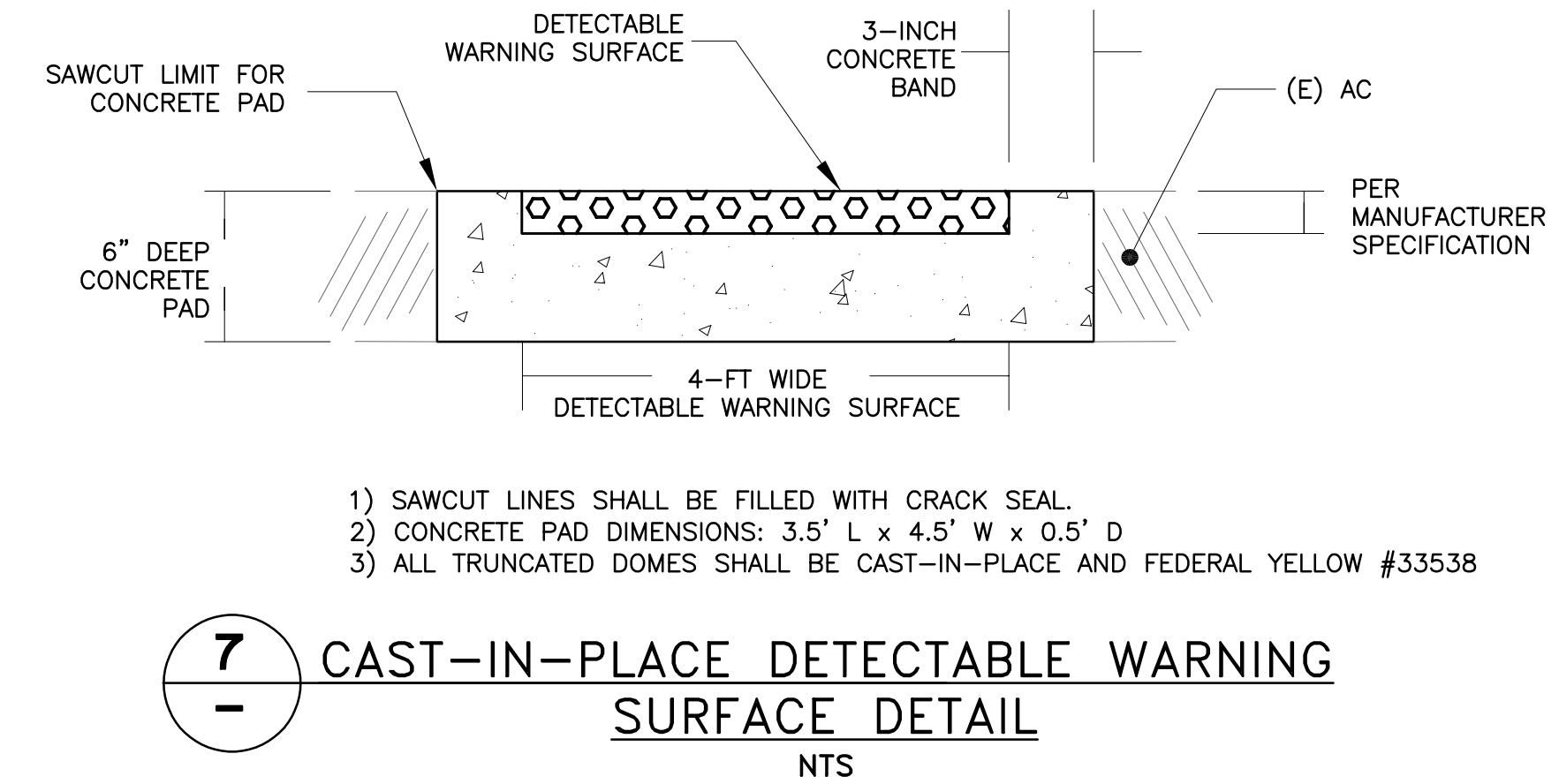

7 CAST-IN-PLACE DETECTABLE WARNING SURFACE DETAIL
NTS

- 1) SAWCUT LINES SHALL BE FILLED WITH CRACK SEAL.
- 2) CONCRETE PAD DIMENSIONS: 3.5' L x 4.5' W x 0.5' D
- 3) ALL TRUNCATED DOMES SHALL BE CAST-IN-PLACE AND FEDERAL YELLOW #33538

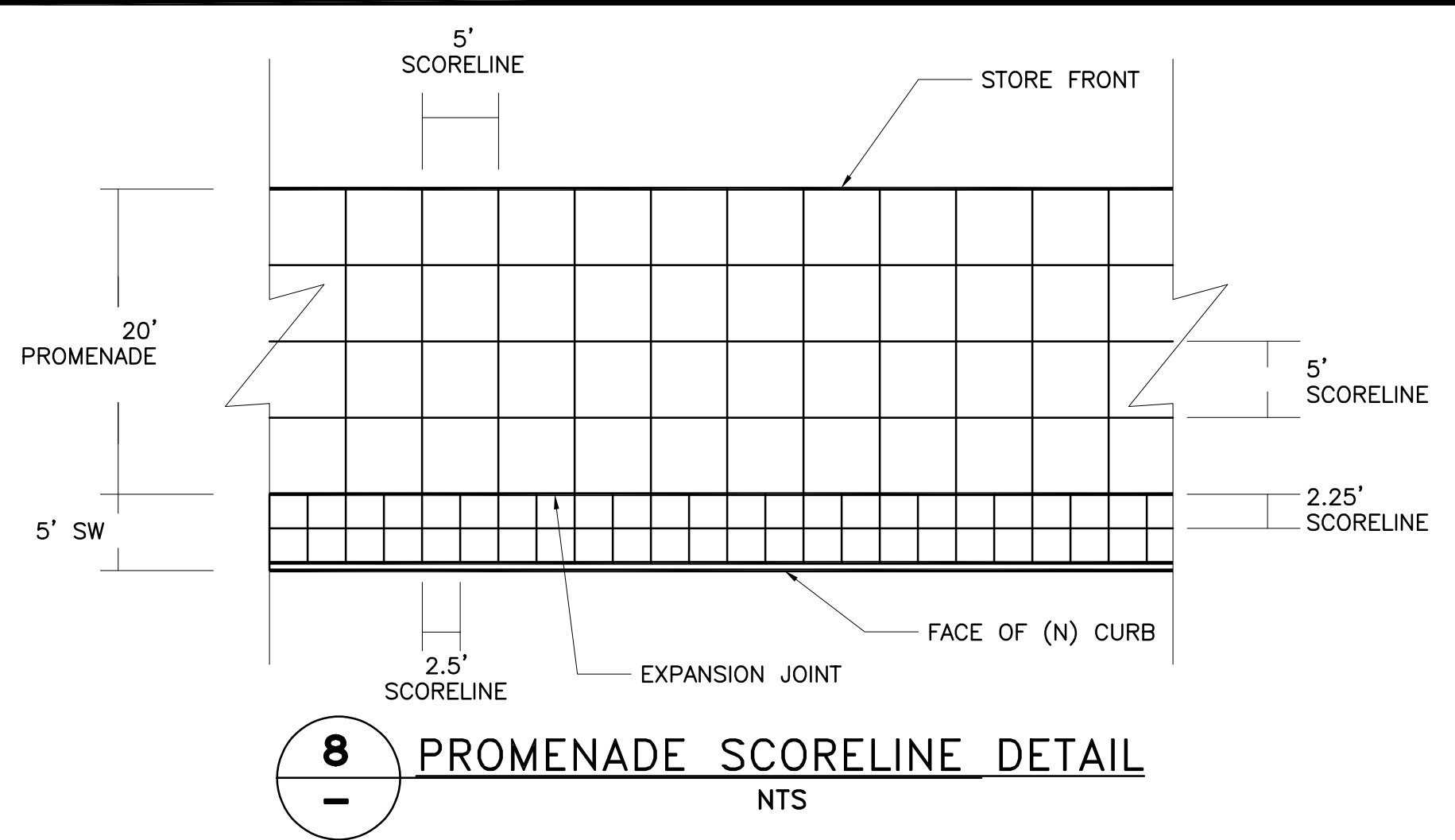

8 PROMENADE SCORELINE DETAIL
NTS

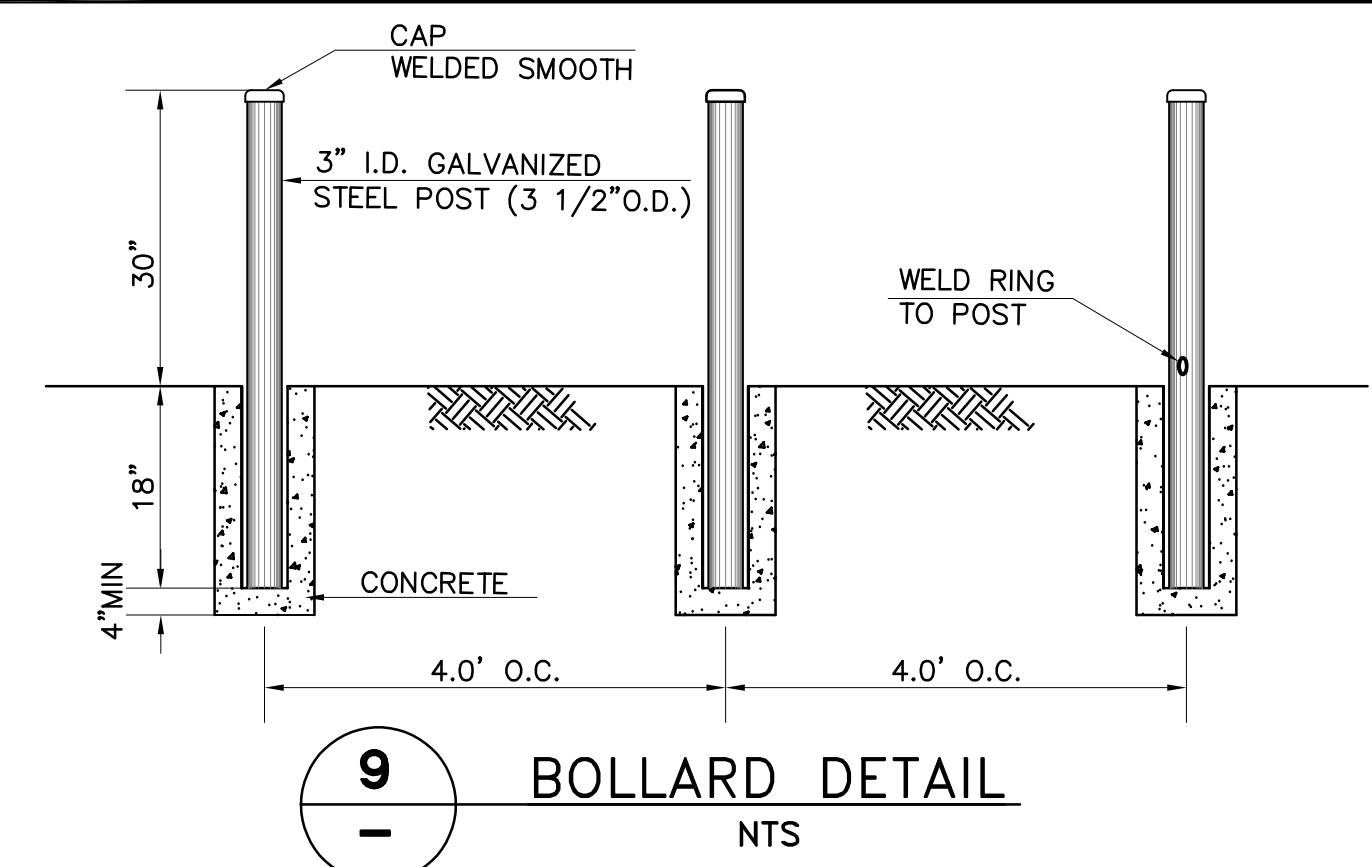

9 BOLLARD DETAIL
NTS

DESIGNED BY: ES	AA, EB	APPROVED BY:	NO.	REVISIONS	DATE
PREPARED BY: CSG Consultants, Inc. 550 PILGRIM DRIVE FOSTER CITY, CA 94404 Phone: (650)522-2500 Fax: (650)522-2599					
PREPARED FOR: SAN MATEO COUNTY HARBOR DISTRICT HARBOR MASTER ONE JOHNSON PIER HALF MOON BAY, CA. 94019					
TITLE: GENERAL DETAILS PILLAR POINT HARBOR RESTAURANT/STORE SIDEWALK EXPANSION PROJECT SAN MATEO COUNTY HARBOR DISTRICT					
REGISTERED PROFESSIONAL ENGINEER LEWIS T. SLININ No. C 39925 CIVIL STATE OF CALIFORNIA			SHEET 12 OF 13		
BID SET 6/6/18			DATE: 6/6/18 JOB#: 16.339		

I:\SERVER2\Clients\DESIGN\16.339 - SMC HMB Pillar Point\2018-05-18 - BID SET\12_GENERAL DETAILS.dwg (11_GENERAL DETAILS). Plotted on: 06-04-18 2:13pm. Plotted by: amira



Construction Best Management Practices (BMPs)

SAN MATEO COUNTYWIDE
**Water Pollution
Prevention Program**
Clean Water. Healthy Community.

Construction projects are required to implement the stormwater best management practices (BMP) on this page, as they apply to your project, all year long.

Materials & Waste Management



Non-Hazardous Materials

- Berm and cover stockpiles of sand, dirt or other construction material with tarps when rain is forecast or if not actively being used within 14 days.
- Use (but don't overuse) reclaimed water for dust control.

Hazardous Materials

- Label all hazardous materials and hazardous wastes (such as pesticides, paints, thinners, solvents, fuel, oil, and antifreeze) in accordance with city, county, state and federal regulations.
- Store hazardous materials and wastes in water tight containers, store in appropriate secondary containment, and cover them at the end of every work day or during wet weather or when rain is forecast.
- Follow manufacturer's application instructions for hazardous materials and be careful not to use more than necessary. Do not apply chemicals outdoors when rain is forecast within 24 hours.
- Arrange for appropriate disposal of all hazardous wastes.

Waste Management

- Cover waste disposal containers securely with tarps at the end of every work day and during wet weather.
- Check waste disposal containers frequently for leaks and to make sure they are not overfilled. Never hose down a dumpster on the construction site.
- Clean or replace portable toilets, and inspect them frequently for leaks and spills.
- Dispose of all wastes and debris properly. Recycle materials and wastes that can be recycled (such as asphalt, concrete, aggregate base materials, wood, gyp board, pipe, etc.)
- Dispose of liquid residues from paints, thinners, solvents, glues, and cleaning fluids as hazardous waste.

Construction Entrances and Perimeter

- Establish and maintain effective perimeter controls and stabilize all construction entrances and exits to sufficiently control erosion and sediment discharges from site and tracking off site.
- Sweep or vacuum any street tracking immediately and secure sediment source to prevent further tracking. Never hose down streets to clean up tracking.

Equipment Management & Spill Control



Maintenance and Parking

- Designate an area, fitted with appropriate BMPs, for vehicle and equipment parking and storage.
- Perform major maintenance, repair jobs, and vehicle and equipment washing off site.
- If refueling or vehicle maintenance must be done onsite, work in a bermed area away from storm drains and over a drip pan big enough to collect fluids. Recycle or dispose of fluids as hazardous waste.
- If vehicle or equipment cleaning must be done onsite, clean with water only in a bermed area that will not allow rinse water to run into gutters, streets, storm drains, or surface waters.
- Do not clean vehicle or equipment onsite using soaps, solvents, degreasers, steam cleaning equipment, etc.

Spill Prevention and Control

- Keep spill cleanup materials (rags, absorbents, etc.) available at the construction site at all times.
- Inspect vehicles and equipment frequently for and repair leaks promptly. Use drip pans to catch leaks until repairs are made.
- Clean up spills or leaks immediately and dispose of cleanup materials properly.
- Do not hose down surfaces where fluids have spilled. Use dry cleanup methods (absorbent materials, cat litter, and/or rags).
- Sweep up spilled dry materials immediately. Do not try to wash them away with water, or bury them.
- Clean up spills on dirt areas by digging up and properly disposing of contaminated soil.
- Report significant spills immediately. You are required by law to report all significant releases of hazardous materials, including oil. To report a spill: 1) Dial 911 or your local emergency response number, 2) Call the Governor's Office of Emergency Services Warning Center, (800) 852-7550 (24 hours).

Earthwork & Contaminated Soils



Erosion Control

- Schedule grading and excavation work for dry weather only.
- Stabilize all denuded areas, install and maintain temporary erosion controls (such as erosion control fabric or bonded fiber matrix) until vegetation is established.
- Seed or plant vegetation for erosion control on slopes or where construction is not immediately planned.

Sediment Control

- Protect storm drain inlets, gutters, ditches, and drainage courses with appropriate BMPs, such as gravel bags, fiber rolls, berms, etc.
- Prevent sediment from migrating offsite by installing and maintaining sediment controls, such as fiber rolls, silt fences, or sediment basins.
- Keep excavated soil on the site where it will not collect into the street.
- Transfer excavated materials to dump trucks on the site, not in the street.
- Contaminated Soils
- If any of the following conditions are observed, test for contamination and contact the Regional Water Quality Control Board:
 - Unusual soil conditions, discoloration, or odor.
 - Abandoned underground tanks.
 - Abandoned wells
 - Buried barrels, debris, or trash.

Paving/Asphalt Work



- Avoid paving and seal coating in wet weather, or when rain is forecast before fresh pavement will have time to cure.
- Cover storm drain inlets and manholes when applying seal coat, tack coat, slurry seal, fog seal, etc.
- Collect and recycle or appropriately dispose of excess abrasive gravel or sand. Do NOT sweep or wash it into gutters.
- Do not use water to wash down fresh asphalt concrete pavement.

Sawcutting & Asphalt/Concrete Removal

- Completely cover or barricade storm drain inlets when saw cutting. Use filter fabric, catch basin inlet filters, or gravel bags to keep slurry out of the storm drain system.
- Shovel, absorb, or vacuum saw-cut slurry and dispose of all waste as soon as you are finished in one location or at the end of each work day (whichever is sooner!).
- If sawcut slurry enters a catch basin, clean it up immediately.

Concrete, Grout & Mortar Application



- Store concrete, grout and mortar under cover, on pallets and away from drainage areas. These materials must never reach a storm drain.
- Wash out concrete equipment/trucks offsite or in a contained area, so there is no discharge into the underlying soil or onto surrounding areas. Let concrete harden and dispose of as garbage.
- Collect the wash water from washing exposed aggregate concrete and remove it for appropriate disposal offsite.

Dewatering

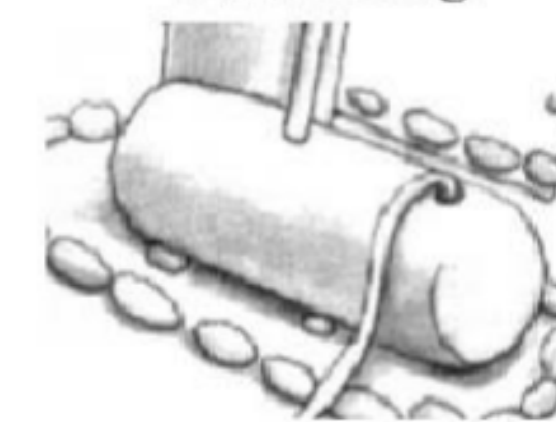

- Effectively manage all run-on, all runoff within the site, and all runoff that discharges from the site. Divert run-on water from offsite away from all disturbed areas or otherwise ensure compliance.
- When dewatering, notify and obtain approval from the local municipality before discharging water to a street gutter or storm drain. Filtration or diversion through a basin, tank, or sediment trap may be required.
- In areas of known contamination, testing is required prior to reuse or discharge of groundwater. Consult with the Engineer to determine whether testing is required and how to interpret results. Contaminated groundwater must be treated or hauled off-site for proper disposal.

Painting & Paint Removal

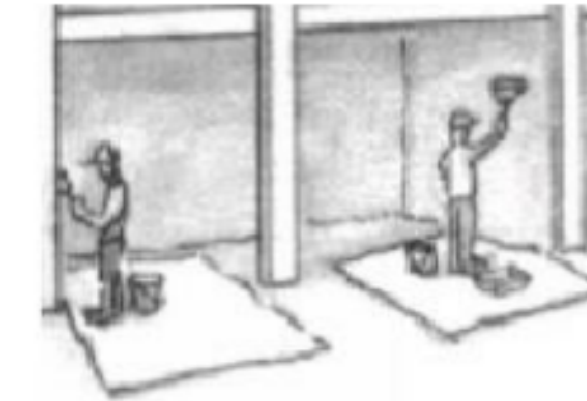

Painting cleanup

- Never clean brushes or rinse paint containers into a street, gutter, storm drain, or surface waters.
- For water-based paints, paint out brushes to the extent possible. Rinse to the sanitary sewer once you have gained permission from the local wastewater treatment authority. Never pour paint down a drain.
- For oil-based paints, paint out brushes to the extent possible and clean with thinner or solvent in a proper container. Filter and reuse thinners and solvents. Dispose of residue and unusable thinner/solvents as hazardous waste.

Paint removal

- Chemical paint stripping residue and chips and dust from marine paints or paints containing lead or tributyltin must be disposed of as hazardous waste.
- Paint chips and dust from non-hazardous dry stripping and sand blasting may be swept up or collected in plastic drop cloths and disposed of as trash.

Landscape Materials



- Contain stockpiled landscaping materials by storing them under tarps when they are not actively being used.
- Stack erodible landscape material on pallets. Cover or store these materials when they are not actively being used or applied.
- Discontinue application of any erodible landscape material within 2 days before a forecast rain event or during wet weather.

Storm drain polluters may be liable for fines of up to \$10,000 per day!



									DATE
DESIGNED: ES	AA, EB								REVISIONS
DRAWN:									NO.
APPROVED:									
PREPARED BY: CSG Consultants, Inc. 550 PILGRIM DRIVE FOSTER CITY, CA 94044 Phone: (650)522-2500 Fax: (650)522-2599									
PREPARED FOR: SAN MATEO COUNTY HARBOR DISTRICT HARBOR MASTER ONE JOHNSON PIER HALF MOON BAY, CA. 94019									
TITLE: CONSTRUCTION BMP'S									
RESTAURANT/STORE SIDEWALK EXPANSION PROJECT SAN MATEO COUNTY HARBOR DISTRICT									
SHEET 13 OF 13									
BID SET 6/6/18					DATE : 6/6/18 JOB#: 16.339				

I:\SERVERS\Clients\DESIGN\16.339 - SMC_HMB_Pillar Point\2018-05-18 - BID SET\13_CONSTRUCTION BMP.dwg (13). Plotted on: 06-04-18 12:14pm. Plotted by: amelia